



Read the operating instructions prior to commissioning

FlexFusion® ELECTRIC SPACE\$AVER (PLUS)



Operating manual

Model

FSEN610
FSEN605

Operating and display elements

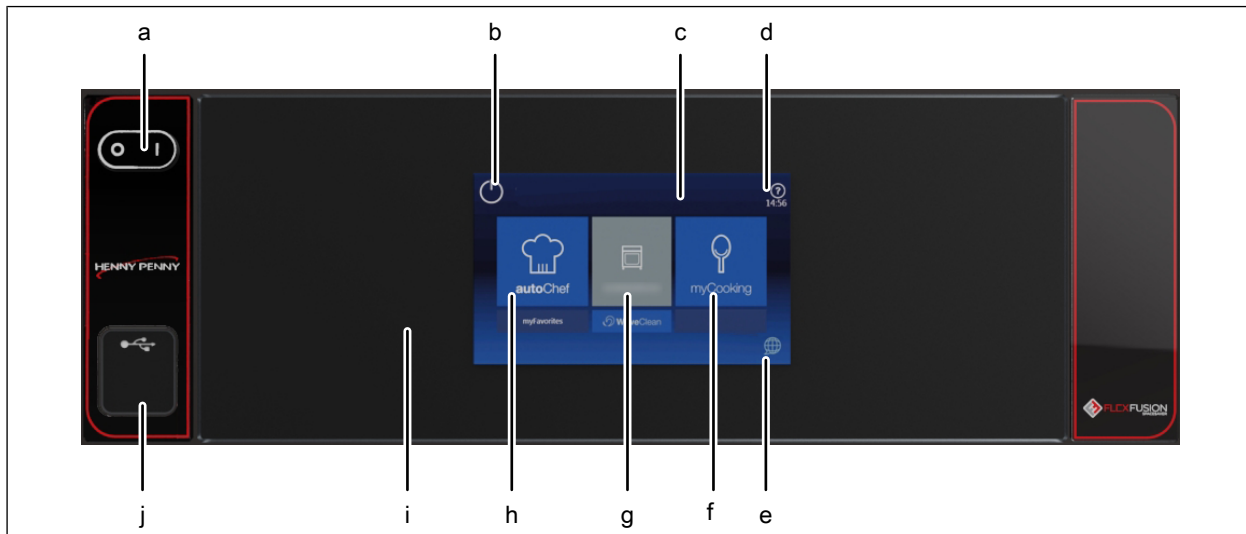

- | | | | |
|---|---------------------------|---|------------------------------------|
| a | On Off "I O" button | f | "Manual cooking" button |
| b | Unit controller button | g | "Unit functions" button |
| c | Information strip | h | "Automatic cooking" button |
| d | Help button | i | Operating element with touchscreen |
| e | Language selection button | j | USB port |

- 1 Introduction 9**
- 1.1 About this manual 9**
- 1.1.1 Explanation of signs 10
- 1.2 Intended use 11**
- 1.3 Warranty 11**
- 2 Safety instructions 12**
- 3 Description of the unit 15**
- 3.1 Overview of the unit 15**
- 3.2 Features 15**
- 3.2.1 Characteristics 15
- 3.2.2 Barcode Scanner 16
- 3.2.3 USB port 16
- 3.2.4 HACCP logging 17
- 3.2.5 VideoAssist 17
- 3.2.6 WaveClean automatic cleaning 17
- 3.2.7 CombiDoctor (self-diagnostic program) 17
- 3.2.8 HoodIn (optional) 17
- 3.3 Operating and cooking modes 17**
- 3.3.1 Operating modes 17
- 3.3.2 Cooking modes 17
- 3.3.3 Expanded cooking functions 18
- 3.3.4 Core temp. measurement 21
- 3.4 Device control Chef’s touch 21**
- 3.5 Loading capacities 23**
- 3.5.1 Plate capacity during regeneration 23
- 3.5.2 Loading capacity 23
- 3.6 Standard settings 24**
- 3.6.1 Temperature standard setting 24
- 3.6.2 Core temperature standard setting 24
- 3.6.3 Cooking chamber humidity standard setting 24
- 4 Operating the unit 25**
- 4.1 Environmentally friendly operation 25**
- 4.2 Switching the unit on and off 26**
- 4.2.1 Switching on 26
- 4.2.2 Switching off 26
- 4.3 Opening and closing the cooking chamber door 26**
- 4.3.1 Opening 26
- 4.3.2 Closing 27
- 4.4 Loading and emptying the unit 27**
- 4.4.1 Loading 27
- 4.4.2 Emptying 27

4.5 Unit functions menu	28
4.5.1 Accessing the main menu	28
4.5.2 Opening the Unit functions menu	29
4.5.3 Changing the basic settings	29
4.5.4 Retrieving unit information	31
4.5.5 Setting the date and time	31
4.5.6 Presetting the language selection	32
4.5.7 Setting favorites	32
4.5.8 Activating and canceling inhibit operation	33
4.5.9 Setting the background lighting	34
4.5.10 Setting the water filter maintenance	34
4.5.11 Possible settings in the parameter level	35
4.5.12 Importing video	36
4.6 Basic functions	37
4.6.1 Setting the cooking temperature	37
4.6.2 Setting the cooking time and continuous operation	38
4.6.3 Using start time selection	40
4.6.4 Setting the core temperature	41
4.6.5 Setting the fan speed and direction of rotation	42
4.6.6 Using Perfection (regeneration)	43
4.6.7 Using PerfectHold	44
4.6.8 Ready2CookSetting	45
4.6.9 Steam Exhaust SystemUsing the (SES)	46
4.6.10 RackControlUsing 2	46
4.6.11 Time2ServeSetting	49
4.6.12 FamilyMixUsing	50
4.6.13 Using continue cooking	51
4.6.14 Setting manual steaming	52
4.6.15 Setting a resting step	53
4.6.16 QualityControlUsing	54
4.6.17 Using LT cooking	55
4.6.18 Using Delta-T cooking	56
4.6.19 Using the barcode scanner	57
4.6.20 Inserting and removing the USB stick	58
4.6.21 Preparing a USB stick for importing and exporting	58
4.6.22 Exporting the HACCP log	58
4.7 Using the core temperature sensor	59
4.7.1 Measuring with a 4-point core temperature sensor	60
4.7.2 Measuring the core temperature when cooking frozen food	60
4.7.3 Core temperature display with time-controlled cooking process	61
4.7.4 Core temperature display outside the cooking process	61
4.8 Manual cooking (myCooking)	61
4.8.1 Opening the Manual cooking menu	62
4.8.2 Creating a cooking program step	62

- 4.9 Creating and managing your own cooking programs 64**
 - 4.9.1 Creating a cooking program 64
 - 4.9.2 Saving the cooking program 65
 - 4.9.3 Exporting a cooking program 69
- 4.10 Automatic cooking (autoChef) 70**
 - 4.10.1 Opening the Automatic cooking menu 70
 - 4.10.2 Finding and opening a cooking program 70
 - 4.10.3 Starting the cooking program 72
 - 4.10.4 Ending the cooking program 72
 - 4.10.5 Modifying the cooking program 72
 - 4.10.6 Deleting a cooking program 73
 - 4.10.7 Exporting and importing a cooking program 74
- 4.11 VideoAssist 76**
 - 4.11.1 Watching a video 76
 - 4.11.2 Deleting a video 76
- 4.12 Pausing and ending operation 77**
 - 4.12.1 Performing a hygiene flush after an extended period of idleness 77
- 5 Cleaning and caring for the unit 78**
 - 5.1 Preventing corrosion 78**
 - 5.2 Removing rust spots 78**
 - 5.3 Cleaning the housing 79**
 - 5.4 Cleaning the door handle, operating elements and control panel .. 79**
 - 5.5 Cleaning the touchscreen 79**
 - 5.6 Cleaning the door seal 80**
 - 5.7 Cleaning the cooking chamber door 80**
 - 5.7.1 Cleaning the door with hygienic glazing 80
 - 5.8 Cleaning the steam outlet 81**
 - 5.9 Cleaning the recirculation hood (optional) 81**
 - 5.10 Removing calcium deposits from the unit 82**
 - 5.11 Using WaveClean to clean the cooking chamber automatically (optional) 82**
 - 5.11.1 Preparing for cleaning 83
 - 5.11.2 Selecting the cleaning level 83
 - 5.11.3 Inserting the cleaning cartridge 84
 - 5.11.4 Starting automatic cleaning 85
 - 5.11.5 Canceling automatic cleaning 85
 - 5.11.6 Ending automatic cleaning 85
 - 5.12 Cleaning the cooking chamber manually 86**
 - 5.12.1 Preparing the cooking chamber 86
 - 5.12.2 Starting the cleaning program 86
 - 5.12.3 Spraying the cleaner 86
 - 5.12.4 Allowing the cleaner to act 86

5.12.5 Starting cleaning	87
5.12.6 Drying the cooking chamber	87
5.13 Removing and installing the air diverter	87
5.14 Inspecting the unit	88
5.14.1 Performing a visual inspection	88
5.14.2 Using CombiDoctor to run the self-diagnosis program (optional)	88
6 Troubleshooting	90
6.1 Emergency operation	90
6.2 Cause of error and remedy	90
6.3 Nameplate	91
7 Carrying out maintenance	92
8 Disposing of unit in an environmentally responsible manner	93
Keyword index	94

1 Introduction

1.1 About this manual

The operating instructions are part of the unit and contain information:

- on safe operation,
- on cleaning and care
- on remedial actions in case of faults.

Observe the following notes and adhere to them:

- Read the operating instructions completely before operating the unit for the first time.
- Make the operating instructions available to the operator at all times at the operating site of the unit.
- Insert any supplements from the manufacturer.
- Keep the operating instructions throughout the service life of the unit.
- Pass on the operating instructions to any subsequent operator of the unit.

Target group The target group of the instruction manual is the operator, who is entrusted with the operation, cleaning and care of the unit.

Figures All figures in this manual are intended as examples. Discrepancies can arise between this and the actual unit.

1.1.1 Explanation of signs

 **DANGER**

Imminent danger

Failure to comply will lead to death or very severe injuries.

 **WARNING**

Potential danger

Failure to comply can lead to death or very severe injuries.

 **CAUTION**

Dangerous situation

Failure to comply can lead do slight to moderately severe injuries.

NOTICE

Property damage

Failure to comply can cause property damage.

INFORMATION

Information

Notes for better understanding and operation of the unit.

Symbol / sign	Meaning
•	Listing of information.
→	Action steps which can be performed in any sequence.
1. 2.	Action steps which must be performed in the specified sequence.
↳	Result of an action performed or additional information relating to it.

1.2 Intended use

This unit is intended to be used solely for commercial purposes, particularly in commercial kitchens.

This unit may only be used with suitable accessories and for the cooking of food.

It is forbidden to use the unit for other purposes, which include the following:

- Washing dishes
- As set-down area in or on the unit
- Storing supplies
- Drying cloths, paper or dishes
- Heating acids, alkaline solutions or other chemicals
- Heating preserved food
- Heating combustible liquids
- Heating rooms
- Cleaning air filters

1.3 Warranty

The warranty is void and safety is no longer assured in the event of:

- Improper conversion or technical modifications of the unit,
- Improper use,
- Improper startup, operation or maintenance of the unit,
- Problems resulting from failure to observe these instructions.

2 Safety instructions

The unit complies with applicable safety standards. Residual risks associated with operation or risks resulting from incorrect operation cannot be ruled out and are mentioned specifically in the safety instructions and warnings.

The operator must be familiar with regional regulations and observe them.

Operation During operation, the following group of individuals must be supervised by an individual who is responsible for safety:

- Individuals with physical, sensory, or mental handicaps, or who lack the knowledge and experience to operate the unit properly.

The supervising individual must be familiar with the unit and the risks associated with it.

Children are not allowed to operate or play with the unit.

Hot surfaces Risk of burns from hot surfaces

- Protect arms and hands by wearing suitable protective gloves.
- Allow surfaces to cool prior to cleaning.
- Remove hot utensils only with suitable protective gloves or potholders.
- Remove containers and baking sheets only with suitable protective gloves or potholders.

Hot liquids Risk of scalding from hot liquids

- Protect arms and hands by wearing suitable protective gloves.
- Remove, transport and empty containers carefully.

Risk of chemical burns from evaporating cleaners

- Follow the instructions of the cleaning agent manufacturer.
- Allow the cooking chamber to cool to a temperature below 60 °C (140 °F) and then clean.

Risk of scalding from steam

- Protect arms and hands by wearing protective gloves.
- Do not hold hands in front of the extractor hood.
- First open the cooking chamber door slightly and allow the steam to escape. Then open the cooking chamber door completely.
- Dry unit completely after cleaning it.

Defective unit Risk of injury from a defective unit

- Disconnect a defective unit from the electrical supply mains.
- Do not operate a defective unit.
- Allow only qualified personnel to repair the unit.

Fire prevention Risk of fire from dirt and grease deposits

- Clean the unit when finished using it.
- Do not use the unit as a deep fat fryer.
- Clean cooking chamber regularly and remove collected grease.

Risk of fire from overheating

- Do not store any combustible objects or plastic containers in the cooking chamber.

Firefighting

- In the event of a fire, disconnect the unit from the electrical supply mains.
- Use a Fire Class F fire extinguisher, never water, to extinguish grease fires. Other fires, for instance, can be extinguished with fire extinguishers suitable for Fire Classes A, B, C, CO₂ fire extinguishers or extinguishing media suitable for the fire class confronted.

Unit on casters Risk of injury from a unit on casters

- Move the unit only for cleaning or maintenance.
- Lock casters during operation.
- Only move an empty unit.

Danger of a line breaking if subjected to high tensile load

- Using a chain to provide strain relief for the connection lines, secure the unit at the installation site so that the connection lines are not put under tension when the unit is moved. The strain relief must be designed for a tensile load of at least 0.6 kN.

Improper cleaning Risk of chemical burns from cleaning agent

- Follow the instructions of the cleaning agent manufacturer.
- Take appropriate protective measures when handling aggressive cleaning agents.

Risk of falling on wet and slippery ground

- Keep the floor in front of the unit clean and dry.

Risk of injury from improper cleaning

- Clean the cooking chamber carefully. The cooking chamber sensor protrudes into the cooking chamber.

Risk of property damage from improper cleaning

- Clean the unit after using it.
- Do not clean the unit with a high-pressure cleaner or water jet.
- Do not clean the housing with highly abrasive or chemically aggressive cleaning agents.

- Do not clean the housing with highly abrasive sponges.
- Follow the instructions of the cleaning agent manufacturer.
- Do not shock the unit by cooling it abruptly.
- Clean the cooking chamber carefully. The cooking chamber sensor protrudes into the cooking chamber.
- Do not use any bleaching or chlorine-containing cleaners or disinfectants.
- Remove rust spots with an abrasive.
- Keep the unit free of calcium deposits.

Hygiene Health risk from insufficient hygiene

- Observe applicable regional hygiene regulations.

Core temperature measurement Risk of injury from overheated core temperature sensor

- Do not heat the core temperature sensor over an open flame.

Improper use Risk of property damage from improper use

- Use only original accessories.
- Train operators regularly.
- Do not heat food warmer plates or cans of preserved food.
- Do not cover air inlet and outlet openings.
- Do not operate the unit at temperatures below 4° C (39 °F).
- Remove the core temperature sensor before the cooked food is removed.
- Insert the core temperature sensor back into the holder after use.

3 Description of the unit

The unit is a hot-air steamer suitable for most cooking methods used in commercial kitchens. Selectable use of hot air, unpressurized live steam, individually, in succession or combined with moist and dry heat.

3.1 Overview of the unit

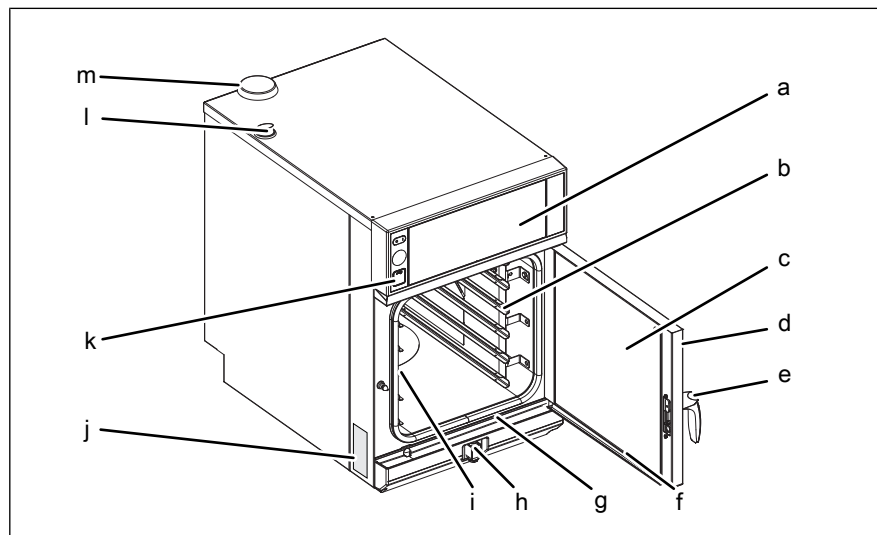

Image: Countertop unit

- | | |
|------------------------|---------------------------------------|
| a Operating unit | h Hand shower (optional) |
| b Hang-in frame | i Core temperature sensor (concealed) |
| c Insulating disk | j Nameplate |
| d Cooking chamber door | k USB port |
| e Door handle | l Steam outlet nozzle |
| f Drain channel, door | m Air inlet nozzle |
| g Drain channel, unit | |

3.2 Features

3.2.1 Characteristics

- Cooking chamber door with hygienic glazing and lighting
- 4-point core temperature controller
- 1-step door lock
- Power optimization system (optional)
- Cooking chamber door, hinged on the right
- Cooking chamber door, hinged on the left (optional)
- Barcode scanner (optional)
- USB interface
- Ethernet interface (optional)

- Hang-in frame

Software

- Cooking programs import function
- Cooking program protection
- Favorites
- ChefsHelp
- QualityControl
- VideoAssist
- FamilyMix
- Time2Serve
- PerfectHold
- ClimaSelect plus
- GreenInside
- Eco mode
- Steam Exhaust System (SES)
- CombiDoctor
- Perfection
- Ready2Cook
- RackControl
- Start time selection
- WaveClean (optional)

3.2.2 Barcode Scanner



Use the barcode scanner to scan the barcode, for instance, on the packaging of the food to be cooked, and transfer it to the unit. The unit then searches for the appropriate cooking program. If several cooking programs are found, they are all listed.

A prerequisite for using the barcode scanner is correct connection of the barcode scanner and a cooking program with the appropriate recognition capability.

3.2.3 USB port

The unit is equipped with a USB port (USB 2.0).

HACCP logs can be exported via the USB port.

A wireless or corded barcode scanner (optional) can be connected to the USB port.

3.2.4 HACCP logging

All cooling programs run are recorded in the HACCP log.
The data are exported via the USB port.

3.2.5 VideoAssist

VideoAssist can be used to display videos with additional explanations regarding operation.

3.2.6 WaveClean automatic cleaning

With WaveClean automatic cleaning, the cooking chamber is cleaned with the aid of a cleaning cartridge intended specifically for the program and then rinsed clean.

3.2.7 CombiDoctor (self-diagnostic program)

CombiDoctor uses a selectable self-diagnostic program to check the components used for climate control and cleaning.

3.2.8 HoodIn (optional)

HoodIn is a space-saving steam condensation feature which is integrated in the Combisteamer.

3.3 Operating and cooking modes

3.3.1 Operating modes



Manual cooking (myCooking)

Individual cooking modes and unit functions can be run directly in the "Manual cooking" operating mode. The various cooking modes and unit functions can be modified individually.



Automatic cooking (autoChef)

In the "Automatic cooking" operating mode, saved cooking programs can be run and, if necessary, modified.

3.3.2 Cooking modes



Steaming

Steaming is a cooking mode in which the food to be cooked is cooked gently by means of steam in a temperature range of 30 °C (86 °F) to 130 °C (266 °F).



Combisteaming

Combisteaming is a cooking mode in which the steaming and convection cooking modes are combined. The temperature range extends from 30 °C (86 °F) to 250 °C (482 °F).

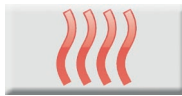

Convection

Convection is a cooking mode, in which the food to be cooked is cooked without additional moisture in a temperature range of 30 °C (86 °F) to 300 °C (572 °F).



Perfection (regeneration)

Perfection is a cooking mode, in which cooled food to be cooked can be kept warm and prepared in a short time in a temperature range of 30 °C (86 °F) to 180 °C (356 °F).



Delta-T cooking

Delta-T cooking is a cooking mode where the cooking temperature depends on the core temperature of the food being cooked.



The cooking temperature is always higher than the current core temperature by the set value (Delta-T value, cooking temperature difference). The resulting cooking time is longer than with other cooking modes.



Delta-T cooking is especially well-suited for general cooking. The food being cooked remains tender and juicy with little weight loss.

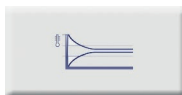

Low-temperature cooking

Low-temperature cooking is a cooking mode, in which the food to be cooked is cooked particularly gently in a temperature range of 30 °C (86 °F) to 100 °C (212 °F).

The cooking time is considerably longer than at higher temperatures, but no supervision is required and the cooking time can be extended considerably without any loss in quality.

The food being cooked remains tender and juicy with little weight loss.



Baking

Baking is a cooking mode in which the texture of the food to be cooked is loosened and then cooked and browned by hot air in a temperature range of 30 °C (86 °F) to 220 °C (428 °F). Before baking takes place, a humidifying process and its associated acting time can be performed.

3.3.3 Expanded cooking functions

Expanded cooking functions can be used to adapt individual cooking steps to the particular food being cooked.

The following expanded cooking functions are available:



PerfectHold

PerfectHOLD is a cooking function, in which the food to be cooked is kept warm in the unit at a temperature range of 50 °C (122 °F) to 100 °C (212 °F) after the actual cooking process, until it is ready to be served.

 Ready2Cook

Ready2Cook (preheating)

For many cooking programs such as baking, for instance, the correct starting temperature is important.

With Ready2Cook, the cooking chamber can automatically be heated or cooled to the correct starting temperature.

A screen-filling display gives information during the procedure about the status.



Start-time selection

INFORMATION

When using start time selection, temperatures that promote the growth of harmful microorganisms on the food being cooked can occur in the cooking chamber. Observe food processing regulations.

Start time selection can be used to set a waiting period until the program starts.

In this way, bottlenecks in production and preparation can be avoided.

The prepared food can be loaded into the unit and the desired cooking program selected.

 SES

Steam Exhaust System (SES)

This function is activated by default for all cooking programs that have a cooking time longer than 6 minutes.

The Steam Exhaust System (SES) is activated automatically shortly before the end of cooking.

After the cooking time, the Steam Exhaust System (SES) extracts the steam from the cooking chamber. It is then possible to open the cooking chamber door without risk of injury.

 RackControl2

RackControl2

RackControl is ideal for rolling cooking.

With the extended RackControl2 cooking function, different foods such as potatoes, cauliflower, peas, carrots and meat can be cooked simultaneously for different times.

RackControl2 monitors the various cooking times in one process. When one cooking time has elapsed, a signal sounds and the food being cooked can be removed.

The set temperature can be changed during an active cooking process, without the process having to be stopped.



ChefsHelp

With the ChefsHelp advanced cooking program, it is possible to insert a cooking step that assists the user further with Information in the form of text and images at a certain time.



FamilyMix

With the expanded cooking function FamilyMix, the appropriate cooking programs are displayed in the *Automatic cooking (autoChef)* menu for the currently set cooking mode. The cooking programs displayed have the same cooking climate and an identical or shorter cooking time. Tapping the individual suggestions transfers the cooking times for the individual products to the RackControl function and these can then be started when desired during the cooking process.



Manual steaming

Manual steaming allows the cooking chamber humidity to be increased during operation.

Manual steaming can only be used in the Convection and Delta T convection cooking modes.

The remaining time for this procedure is displayed during steaming. After the Drop symbol has been touched, the set value is displayed for 3 seconds.



Idle time

With the idle time expanded cooking function, a cooking step can be inserted during which the heating and the fans are programmed to switch off for a certain period of time.



QualityControl

With the expanded QualityControl cooking function, the control senses the amount loaded automatically and adjusts the individual cooking parameters in autoChef. This ensures first-class quality consistently.

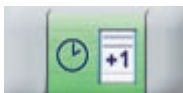

Continue cooking button

The Continue cooking button lets you continue the cooking process for a predefined period of time after the cooking program has ended.



Time2Serve

With the Time2Serve advanced cooking function, different products are ready to be served at the same time.

The serving time is specified. The combi-steamer signals when it has reached a remaining cooking time for a product. A signal sounds and the food to be cooked is loaded successively during an active cooking process. The cooking time is shortened, conserving resources.



ClimaSelect plus

The ClimaSelect plus advanced cooking function optimizes the atmosphere in the cooking chamber. Steam is added in small amounts; the atmosphere can be controlled individually.

3.3.4 Core temp. measurement

When measuring the core temperature, the temperature inside the food is measured with a core temperature sensor.

As soon as the target core temperature is reached, the cooking process is automatically ended or, in the case of a multi-step cooking process, the next step is started.

The use of core temperature measurement offers the following benefits:

- Reduced energy and water consumption
- No overcooking
- Less weight lost by the food being cooked
- High HACCP safety

3.4 Device control Chef's touch

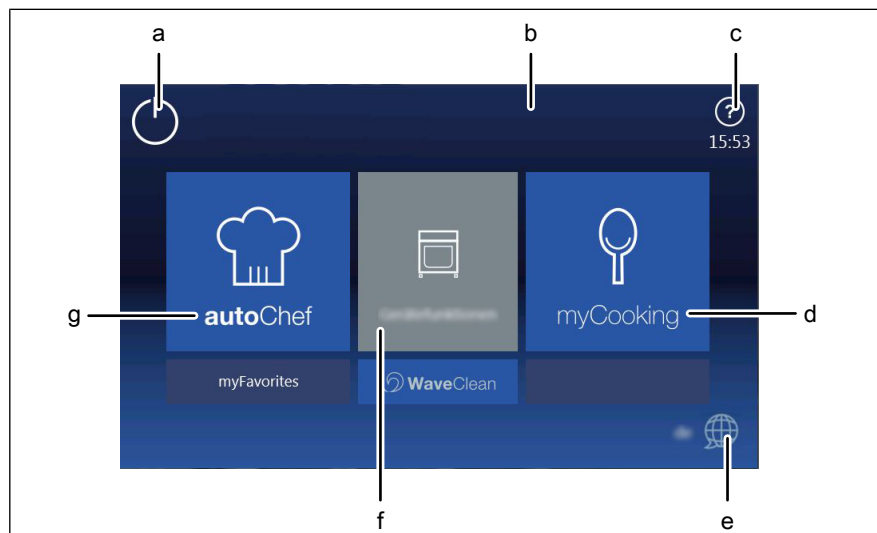

Image: Main menu

- | | | | |
|---|--------------------|---|---------------------------|
| a | Stand-by button | e | Language selection button |
| b | Information strip | f | "Unit functions" button |
| c | FlexiHelp button | g | "autoChef" button |
| d | "myCooking" button | | |

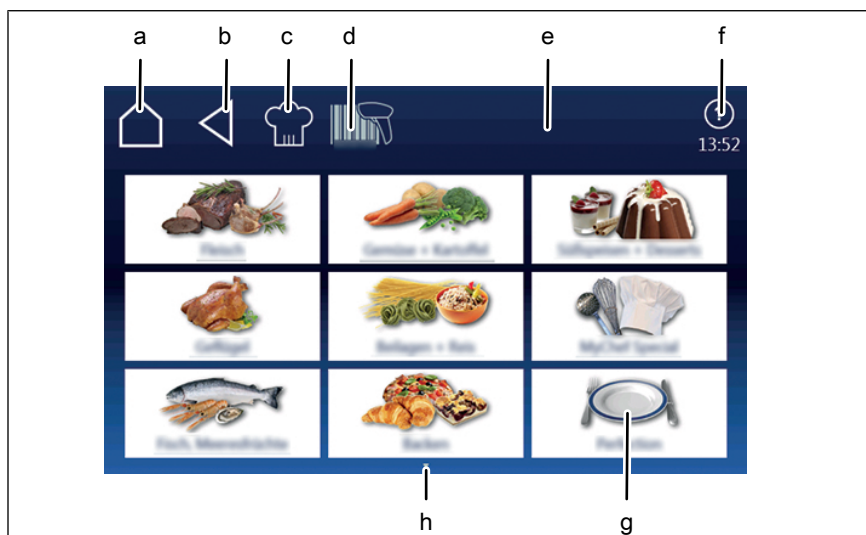

Image: "Automatic cooking" menu, autoChef

- a *Main menu* button
- b *Back* button
- c *autoChef* button
- d *Barcode scanner* button
- e Information strip
- f *Help* button
- g *Category* field
- h *Next page* arrow symbol

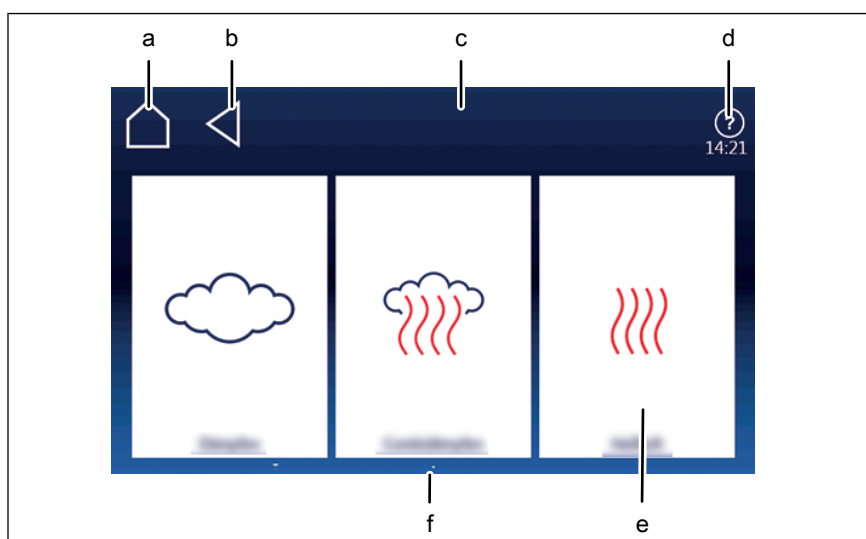

Image: "Manual cooking" menu

- a *Main menu* button
- b *Back* button
- c Information strip
- d *Help* button
- e "Convection" field
- f *Next page* arrow symbol

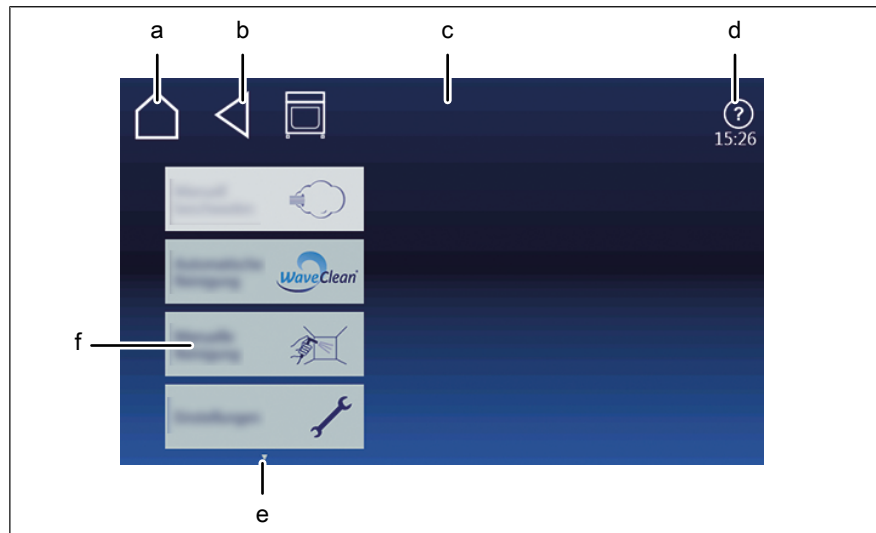

Image: "Unit functions" menu

- | | | | |
|---|-------------------|---|------------------------|
| a | Main menu button | d | Help button |
| b | Back button | e | Next page arrow symbol |
| c | Information strip | f | Manual cleaning field |

3.5 Loading capacities

3.5.1 Plate capacity during regeneration

The cooking time and cooking temperature depend on the number of plates in the cooking chamber.

Version	Plate diameter
	28 cm
610	12
605	6

3.5.2 Loading capacity

Version	max. (kg (lb)) per shelf	max. (kg (lb)) per unit
610	15 (33,1)	30 (66,2)
605	10 (22,1)	20 (44,1)

3.6 Standard settings

3.6.1 Temperature standard setting

The adjustment range for the cooking chamber temperature depends on the cooking mode .

Cooking mode	Standard value (°C (°F))	Setting range (°C (°F))	Change increments (°C (°F))
Steaming	100 (212)	30 (86) - 130 (266)	1 (33,8)
Combisteaming	150 (302)	30 (86) - 250 (482)	1 (33,8)
Convection	180 (356)	30 (86) - 300 (572)	1 (33,8)
Regeneration	50 (122)	30 (86) - 180 (356)	1 (33,8)

3.6.2 Core temperature standard setting

The adjustment range for the core temperature depends on the cooking mode.

Cooking mode	Standard value (°C (°F))	Setting range (°C (°F))	Change increments (°C (°F))
Steaming	70 (158)	0 (32) - 99 (210,2)	1 (33,8)
Combisteaming	70 (158)	0 (32) - 99 (210,2)	1 (33,8)
Convection	70 (158)	0 (32) - 99 (210,2)	1 (33,8)
Regeneration	50 (122)	0 (32) - 99 (210,2)	1 (33,8)

3.6.3 Cooking chamber humidity standard setting

Cooking chamber humidity setting range depends on the cooking mode.

Cooking mode	Standard value (%)	Setting range (%)	Change increments (%)
Steaming	100	90 - 110	90 - 100 - 110
Combisteaming	90	20 - 100	20 - 40 - 70 - 90 - 100
Convection	100	0 - 100	0 - 25 - 50 - 75 - 100
Regeneration	100	0 - 100	0 - 25 - 50 - 75 - 100

4 Operating the unit

NOTICE

Blockage of the drain in the cooking chamber

Food debris, skin and bones can clog the drain and pump.

- For very fatty food, place a sieve or perforated GN container in the lowest rack.
- After each cooking process, take a close look in the cooking chamber and pick up any residues and dispose of them properly.

INFORMATION

The drain in the cooking chamber must be free during operation.

Before loading the cooking chamber

- Remove any food remains from the cooking chamber.
- Check the drain sieve for cleanliness.
- Do not place GN containers or trays on the drain in the cooking chamber.

INFORMATION

Explanatory video clips can be selected under VideoAssist by press the Help button.

INFORMATION

Reduction of acrylamide level

Regulation EU 2017/2158 applies in Europe with effect from 2018.04.11.

This requires that the lowest possible acrylamide level must be achieved when cooking potato products.

MKN therefore recommends the following for potato products:

- Do not exceed a cooking temperature of 220 °C (428 °F) as long as the food manufacturer states, that this is safe for his product.
- Avoid excessive cooking.
- If possible, use pre-blanching products.
- Observe the cooking instructions on the product packaging or otherwise stated by the food manufacturer.

4.1 Environmentally friendly operation

When used properly, this combi-steamer has very low energy consumption.

Reduce the energy consumption in the following manner:

- Avoid continuous operation - the combi-steamer heats up very quickly so that continuous operation is not necessary.

- Use the full capacity of the cooking chamber - if necessary, use a combi-steamer with a smaller cooking chamber.

4.2 Switching the unit on and off

4.2.1 Switching on

- Press the *On Off "I O"* button to "I".
 - ↳ The unit is now on.
 - ↳ The control system starts the power-on process automatically. The progress bar at the lower edge of the touchscreen displays the status of the process.
 - ↳ The main menu appears after 1 minute and the unit is ready for use.

4.2.2 Switching off

INFORMATION

Fans may continue to run for cooling; the unit's control system is disconnected from power.

- Press the *On Off "I O"* button to "O".
 - ↳ The unit is now off.

4.3 Opening and closing the cooking chamber door

4.3.1 Opening

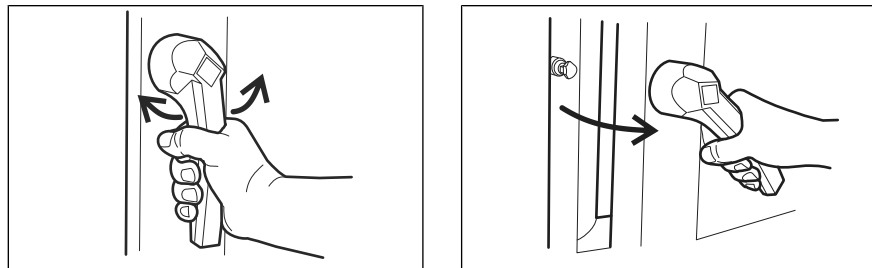

Image: Opening the 1-step door lock

1. Rotate the door handle counterclockwise or clockwise.
 - ↳ The cooking chamber door opens.

INFORMATION

If the door handle is released, it returns automatically to its initial position.

2. Open the cooking chamber door completely.

4.3.2 Closing

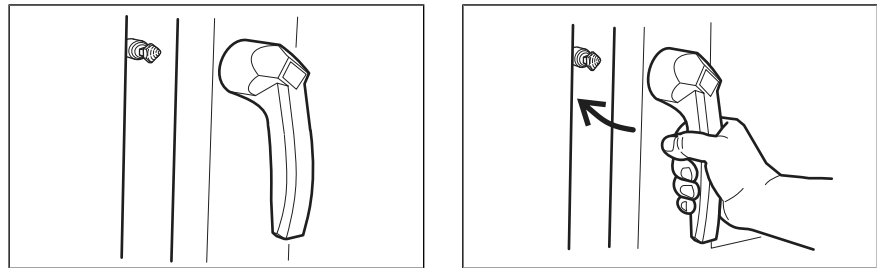

Image: Closing the 1-step door lock

Prerequisite Door handle in initial position

→ Close the cooking chamber door with pressure.

↳ The cooking chamber door is closed.

4.4 Loading and emptying the unit

⚠ CAUTION

Risk of scalding from hot liquid

- Do not insert food trays with liquid or liquefying food above eye level.
- Use only suitable trays to hold food. The food-containing trays must rest securely on the support brackets.
- Always insert the food-containing trays into the U-rails.

⚠ CAUTION

Risk of property damage and personnel injury from exceeding the loading capacity

- Do not exceed the maximum loading capacity.

INFORMATION

To not use bent or damaged hang-in frame.

4.4.1 Loading

1. Open cooking chamber door.
2. Insert food-containing trays into the hang-in frame.
3. Close the cooking chamber door.
4. Start the cooking process.

4.4.2 Emptying

1. Open cooking chamber door.
2. Remove the food-containing trays.
3. Remove all leftover foodstuff from the drainage sieve.

- 4. Leave the cooking chamber door slightly ajar.
 - ↳ This extends the service life of the door seal.
 - ↳ No moisture builds up in the cooking chamber.

4.5 Unit functions menu

Various functions or settings can be selected in the *Unit functions* menu.

INFORMATION

All unit functions can also be accessed from within a cooking program by tapping the *blue* tab.

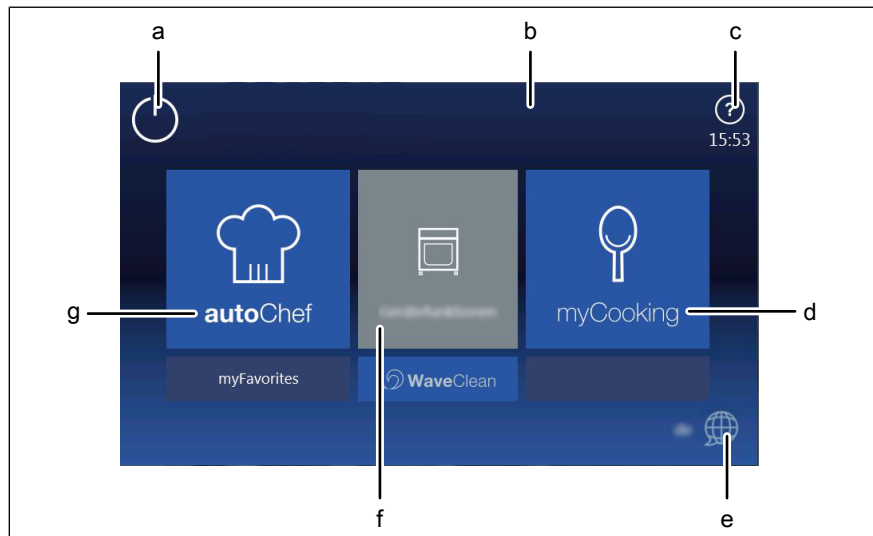

Image: Main menu

- a Stand-by button
- b Information strip
- c FlexiHelp button
- d "myCooking" button
- e Language selection button
- f "Unit functions" button
- g "autoChef" button

INFORMATION

The equipment information is displayed without entering a password.

4.5.1 Accessing the main menu

INFORMATION

The main menu can be accessed directly from every program step.

Prerequisite Open the *Cooling program* or *Settings* menu



1. Tap the *Back* button.
 - ↳ The previous menu or program step is displayed.
2. Repeat as many times as necessary.

3. Tap the *Back* button twice.
 - ↳ All program steps are skipped over.
 - ↳ The main menu appears on the display.

4.5.2 Opening the Unit functions menu

Prerequisite Unit is on
The Main menu is displayed

- Tap the "Unit functions" button.
- ↳ The *Unit functions* menu is displayed.

4.5.3 Changing the basic settings

INFORMATION

The basic settings for operation can be displayed, changed and exported by entering the password "111".

Opening the setting menu

Prerequisite *Unit functions* menu open

1. Tap the "Settings" field.
 - ↳ The *PIN* window opens.

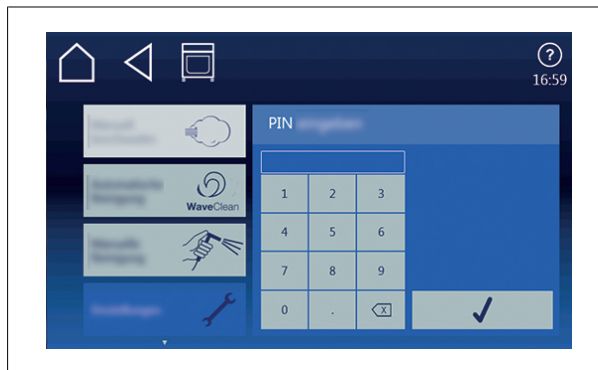

2. Enter password.
3. Tap the *Confirm* button.
 - ↳ The *Unit settings* menu is displayed.
 - ↳ Basic settings can be changed.

In addition to those described in this chapter, there are the following further functions.

Audio settings

Selection of the volume of the signal tones.

Operation lock

Various settings as to whether and when operation lock is to be activated.

Entering and changing the code word.

Standby mode

Deactivate the operation inhibit to set the standby mode.

When the standby mode is active, the touchscreen goes dark after a set time. The cooking chamber light switches off.

Setting the background lighting

This setting is used to reduce the brightness of the touchscreen.

CombiDoctor

CombiDoctor uses a selectable self-diagnostic program to check the components for climate control and cleaning.

Delete user's own cooking programs

Delete all the cooking programs created by the user.

Setting units

Set the units for temperature and liquid quantities.

The possibilities for temperature are °C and °F.

The possibilities for volume are mL, fl.oz (Imp.) and fl.oz (US)

Display the error memory

Retrieve stored faults for forwarding to service partners.

Import HansDampf programs

Import existing HansDampf programs.

Importing manufacturer's cookbook

Import the cookbooks provided by the manufacturer.

Select cookbook

Select the cookbooks typical of the country.

Cookbook lock

Lock function for the cooking programs in autoChef.

Setting	Function
Unlocked	Deleting, changing and overwriting the cooking programs is possible
Disabled	Changes in the cooking steps, for example temperature increases, are possible. The preset values apply again the next time the cooking program is selected.
Fully locked	The cooking program can only be used in the way it has been stored. Changes in the cooking steps are not possible.

Exporting log data

Export of log data for forwarding to the service technician.

Load OEM settings

Special settings can be loaded.

Eco display on or off

Set the Eco display function.

Select signal tones

Selection of one of the four possible signal tones.

Software update

Update of the software via a USB flash drive.

Import additional content

Import of additional content via a USB flash drive.

4.5.4 Retrieving unit information

INFORMATION

The unit information contains data on the software and hardware version, the serial number of the unit and contact data.

Prerequisite The *Setting* menu is displayed



- Tap the "Unit information" field.
- ↳ The *Unit information* window is displayed.
- ↳ Unit information can now be read.

4.5.5 Setting the date and time

INFORMATION

Observe the displayed date and time format carefully. If values are invalid, the entry is not accepted.

Prerequisite *Settings* menu displayed

1. Tap the "Set date and time" field.
- ↳ The *Setting* window opens.
- ↳ The *Keyboard* opens.

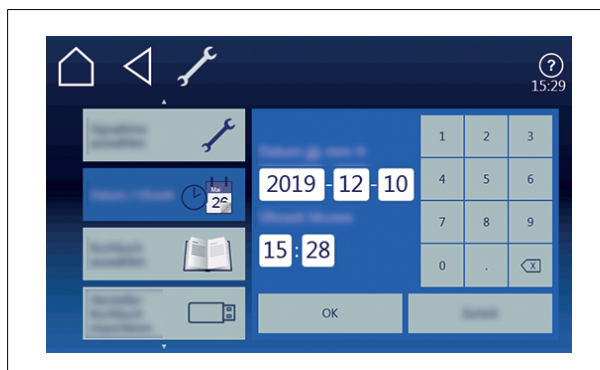

2. Enter the date and time.
3. Tap the "Confirm" button.
- ↳ The *Keyboard* closes.
- ↳ The date and time are set.

4.5.6 Presetting the language selection

INFORMATION

A maximum of 5 languages can be specified for language selection in the main menu.

INFORMATION

Highlighted fields represent the specified languages.

Fields that are not highlighted are languages that have not been specified.

INFORMATION

The currently set language cannot be deselected.

Prerequisite *Settings* menu displayed

1. Tap the "Language selection" field.
↳ The *Languages* menu is displayed.

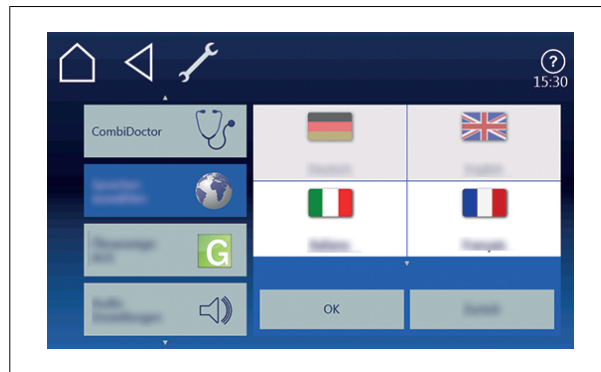

2. The language is selected or deselected by tapping the fields with national flags.
↳ The selected languages are displayed.
3. Tap the "OK" button.
↳ The languages available for language selection are preset and available in the main menu.

4.5.7 Setting favorites

Which view appears on the control panel once the unit is started is selected in the *Settings for favorites*. This limits the functions that can be used by the operator.

Prerequisite *Unit functions* menu open

1. Tap the "Settings for favorites" field.
↳ The *Settings for favorites* window is displayed.

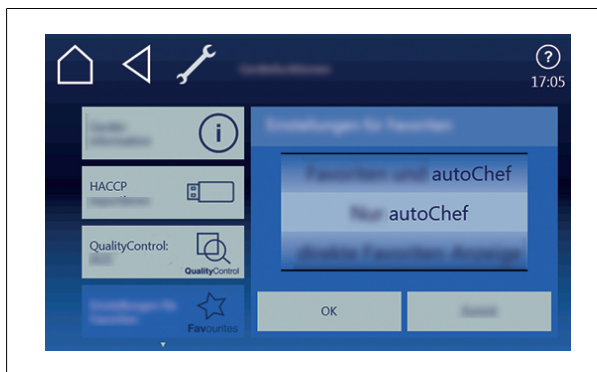

2. Use a swipe gesture to set the roller to the desired display.
3. Tap the "OK" button.
 - ↳ The *Settings for favorites* window closes.
 - ↳ The favorites are set.

4.5.8 Activating and canceling inhibit operation

INFORMATION

The display can be locked either by tapping and holding the information bar or automatically after a specified time without touching the display. The time until the display is locked is set in the parameter level.

Activating inhibit operation

Prerequisite The "Inhibit operation ON" function is activated in the *Setting* menu

- Tap and hold the center of the information strip for 3 seconds.
 - ↳ The Help button disappears and the lock symbol appears in the information strip.
 - ↳ The touchscreen is locked.

Canceling inhibit operation

Prerequisite Touchscreen is locked

1. Tap the lock symbol.
 - ↳ The keyboard opens.
 2. Enter password.
 - ↳ Enter the password "369" to unlock the touchscreen.
- ↳ The lock symbol and the keyboard disappear. The *Help* button appears in the information strip and the touchscreen can be operated.

4.5.9 Setting the background lighting

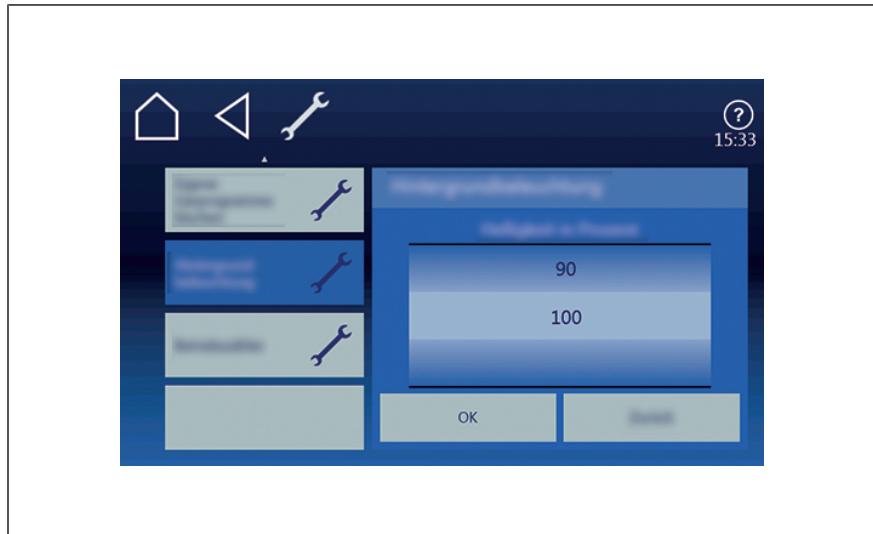

Image: Setting the brightness

Prerequisite The *Settings* menu is displayed

1. Tap the "Background lighting" field.
2. The *Brightness in percent* menu is displayed.
 - ↳ The roller shows the current value.
3. Using a swipe gesture, set the roller to the desired value.
4. Press the "OK" button.
 - ↳ The background lighting is set.

4.5.10 Setting the water filter maintenance

Prerequisite *Settings* menu displayed

1. Tap the "Water filter maintenance" field.



2. The *Water filter maintenance* menu is displayed.
 - ↳ The value entered for when to remind you about water filter maintenance is displayed.
 - ↳ The amount of water filtered since the last filter change is displayed.
 - ↳ The value for water filter maintenance can be entered on the keyboard and confirmed by pressing the "OK" field.

4.5.11 Possible settings in the parameter level

Prerequisite The *Settings* menu is displayed

1. Tap the "Settings parameters" field.
 - ↳ The *Settings parameters* menu is displayed.
 2. Using a swiping gesture, set the rollers to the desired parameter.
 - ↳ The designation of the selected parameter is displayed.
 3. Tap the "Read" button.
 - ↳ The current value of the selected parameter is displayed.
 4. Delete the current value with the keyboard.
 5. Enter the new value with the keyboard.
 6. Tap the "Write" button.
 - ↳ The displayed value is adopted for this parameter.
- ↳ The parameter is changed.

Basic setting parameters

The unit is delivered with presets. The values in the following list can be modified in the parameter level.

Basic setting	Parameter s	Standard value	Range of adjustment	Explanation
Lockscreen				
Lockscreen	662	0	0 = Deactivated 1 = Activated	Activate or deactivate screen locking. Screen locking is activated after a certain period of time if entries are no longer made on the touchscreen.
Password	7	111	0 — 300	The password for the basic settings can be changed in this range.
Cooking modes				
Preselected steaming temperature	9	100	30 °C (86 °F) — 130 °C (266 °F)	Preset temperature for steaming
Preset combisteaming temperature	10	150	30 °C (86 °F) — 250 °C (482 °F)	Preset temperature for combisteaming
Preselect hot air temperature	11	180	30 °C (86 °F) 250 °C (482 °F)—	Preset the temperature for hot air
Preset regeneration temperature	12	130	30 °C (86 °F) — 180 °C (356 °F)	Preset temperature for regeneration
Ready2Cook				
Ready2Cook Active	607	1	0 = not activated 1 = Activated	Indicates whether or not the presetting is activated.
Preheating temperature Ready2Cook	4	15	0 — 30%	When loaded a full charge of large masses (roasts, loaf of bread), increase the preheat temperature so that the oven temperature does not drop too suddenly.

FM05-161-H

Basic setting	Parameters	Standard value	Range of adjustment	Explanation
Cooking				
SES: Use at the end of the cooking program	624	1	0 = Deactivated 1 = Activated	Presetting for Steam Exhaust System when creating a new cooking program
Query: Restart after cooking program is interrupted	697	0	0 = No query 1 = Query only with AutoChef 2 = Query always activated	Setting for the behavior after an interruption of the cooking program
Apply changes after the end of the cooking program	696	0	0 = Do not apply 1 = Apply	Automatic saving of changes made (save at the end of a cooking program).
MagicHood				
Time extension for air recirculation hood	5	60	0 — 600 s	Condensation hood after-running time after opening the cooking chamber door

4.5.12 Importing video

Prerequisite WMV format

Data size < 50 MB

1. On a USB stick, create the directory *VideosCustom*.
2. Save the desired video in this directory.
↳ USB stick prepared.
3. Insert USB stick into MultiPort.
4. Open the *Unit functions* menu.
5. Open the *Settings* menu.
6. Select the *Import videos* menu.

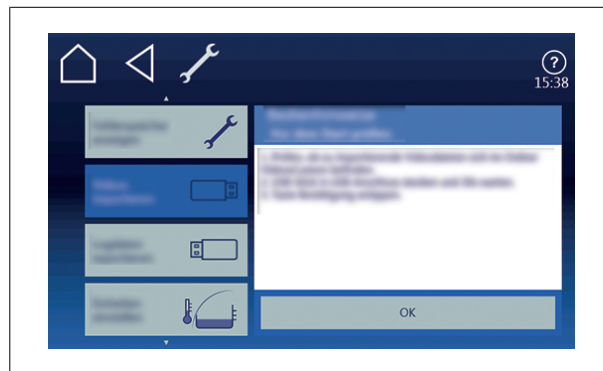

7. Follow the operating instructions.
↳ Video imported.

4.6 Basic functions

4.6.1 Setting the cooking temperature

NOTICE

Increased wear

Continuous use of the device with cooking temperatures above 250 °C (482 °F) leads to increased wear.

INFORMATION

The temperature range differs, depending on the cooking mode. At a cooking temperature outside the allowed temperature range, the display turns red.

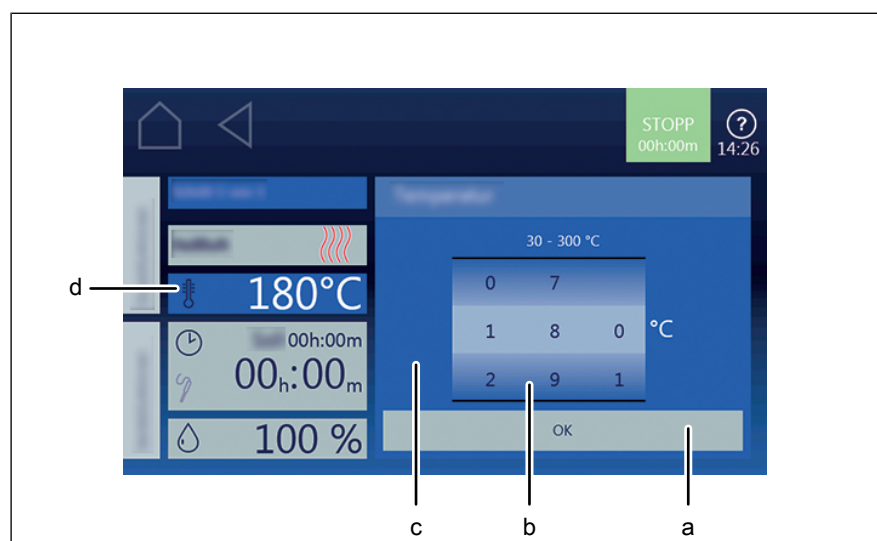

Image: Setting the cooking temperature window

- | | |
|------------------|---------------------|
| a Confirm button | c Setting window |
| b Rollers | d Temperature field |

Prerequisite Cooking program selected

1. Tap the *Cooking temperature* field.
 - ↳ The *Setting* window is displayed.
 2. Tap the *Temperature* field.
 3. Using a swipe gesture, set the rollers to the desired temperature.
 - ↳ Swipe up / down to increase / decrease the cooking temperature.
 4. Tap the *Confirm* button.
 - ↳ The *Setting* window closes.
 - ↳ The *Cooking mode* window displays the set cooking temperature.
- ↳ The cooking temperature is set.

4.6.2 Setting the cooking time and continuous operation

Setting the cooking time

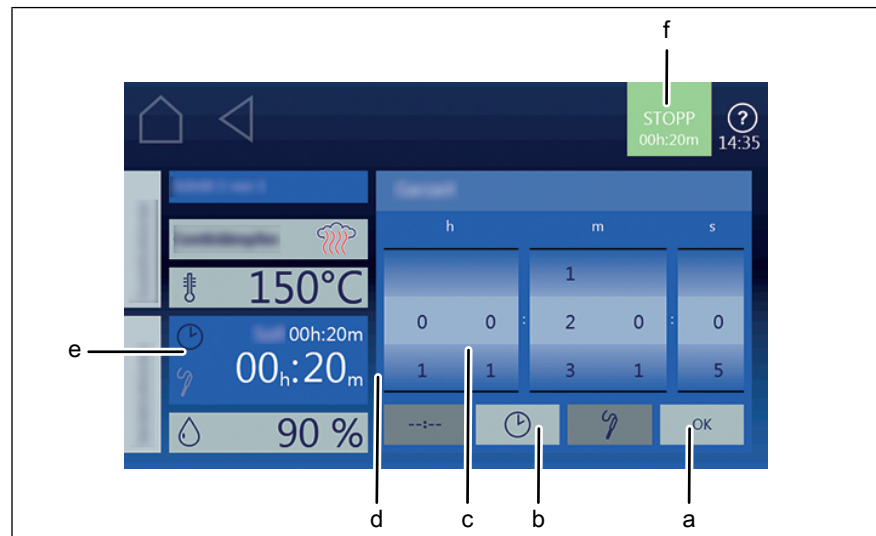

Image: Setting the cooking time

- | | | | |
|---|---------------------|---|--------------------|
| a | OK button | d | Setting window |
| b | Cooking time button | e | Cooking time field |
| c | Rollers | f | Start button |

Prerequisite Cooking program selected

1. Tap the *Cooking time* field.
↳ The *Setting* window is displayed.
2. Tap the *Cooking time* button.
3. Use a swipe gesture to set the rollers to the desired value.
↳ Up or down, cooking time is increased or decreased.
4. Tap the *OK* button.
↳ The *Setting* window closes.
↳ The *Cooking mode* window shows the set cooking time.
↳ The cooking time is set.

Setting continuous operation



Image: Setting the cooking time to continuous operation

- | | | | |
|---|-----------------------------|---|--------------------|
| a | OK button | d | Cooking time field |
| b | Continuous operation button | e | Start button |
| c | Setting window | | |

Prerequisite Cooking program selected

1. Tap the *Cooking time* field.
 - ↳ The *Setting* window is displayed.
 2. Tap the *Continuous operation* button.
 3. Tap the *OK* button.
 - ↳ The *Setting* window closes.
 - ↳ The *Cooking mode* window shows the set cooking time.
- ↳ The cooking time is set to continuous operation and ends after 24 hours.

INFORMATION

A cooking step which is running in continuous operation can be converted to Rest time.

4.6.3 Using start time selection

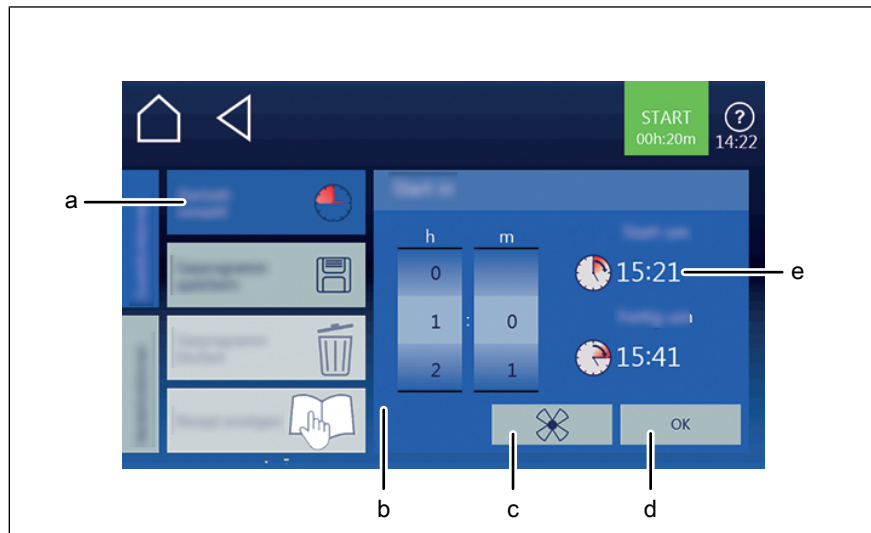

Image: Changing the "Start time selection setting" window

- | | | | |
|---|----------------------------|---|------------------|
| a | Start time selection field | d | Confirm button |
| b | Start time setting window | e | Start time field |
| c | Fan button | | |

Prerequisite Cooking program selected

Additional functions menu open

1. Tap the *Start time selection* field.
 2. Using a swipe gesture, set the rollers to the desired temperature.
 - ↳ Swipe up or down.
 - ↳ The start time is set in minutes and seconds.
 3. Tap the *OK* button.
 - ↳ The *Start time selection* window shows the set start time.
 - ↳ The beginning and end of the start time is displayed in real time.
- ↳ Start time selection is set for time control.

4.6.4 Setting the core temperature

INFORMATION

You can find further information on working with the core temperature sensor under Using the core temperature sensor.

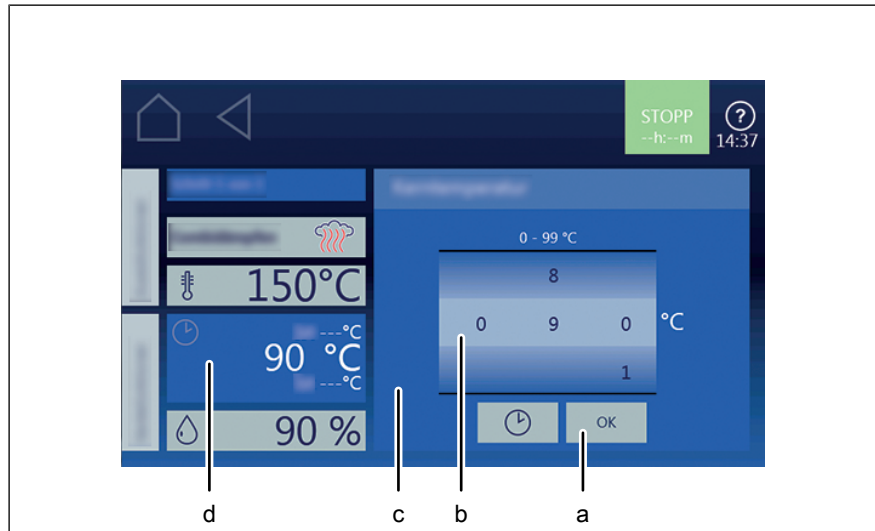

Image: "Core temperature setting" window

- | | | | |
|---|--------------------|---|------------------------|
| a | Confirm button | c | Setting window |
| b | Temperature roller | d | Core temperature field |

Prerequisite Cooking program selected
Cooking time set

1. Tap the *Cooking time* field.
 - ↳ The *Cooking time* setting window is displayed.
2. Tap the *Core temperature* field.
 - ↳ The *Core temperature* setting window is displayed.
3. Use a swipe gesture to set the rollers to the desired value.
 - ↳ Swipe up or down, core temperature is increased or decreased.
4. Tap the *Confirm* button.
 - ↳ The *Setting* window closes.
 - ↳ The *Cooking time* field changes to the *Core temperature* field.

4.6.5 Setting the fan speed and direction of rotation

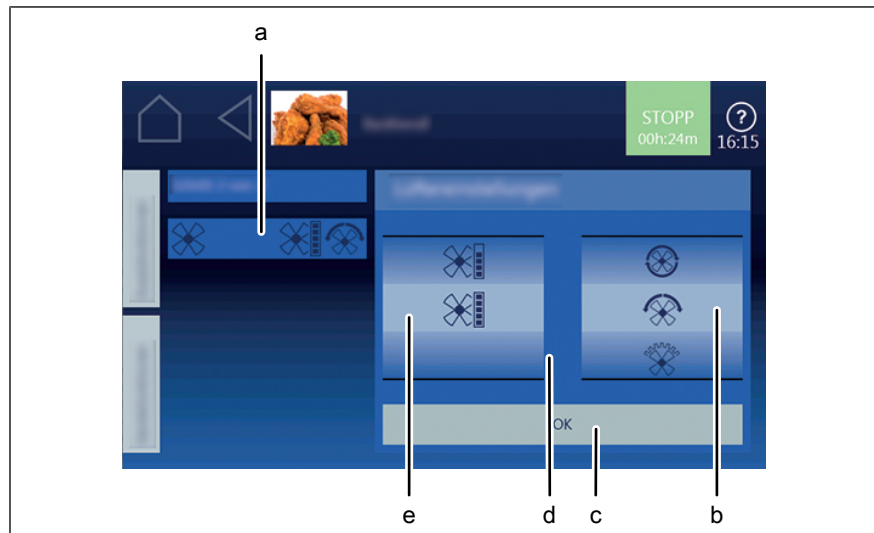

Image: Setting the fan speed and direction of rotation

- | | | | |
|---|------------------------------|---|------------------|
| a | Fan setting field | d | Setting window |
| b | Direction of rotation roller | e | Fan speed roller |
| c | OK button | | |

Prerequisite Cooking program selected

1. Tap the *Fan setting* field.
↳ The setting window opens.
2. Use a swipe gesture to set the *Fan speed* to the desired value.
3. Use a swipe gesture to set the *Direction of rotation* to the desired value.
4. Tap the *OK* button.
↳ The fan speed and direction of rotation are set.

4.6.6 Using Perfection (regeneration)

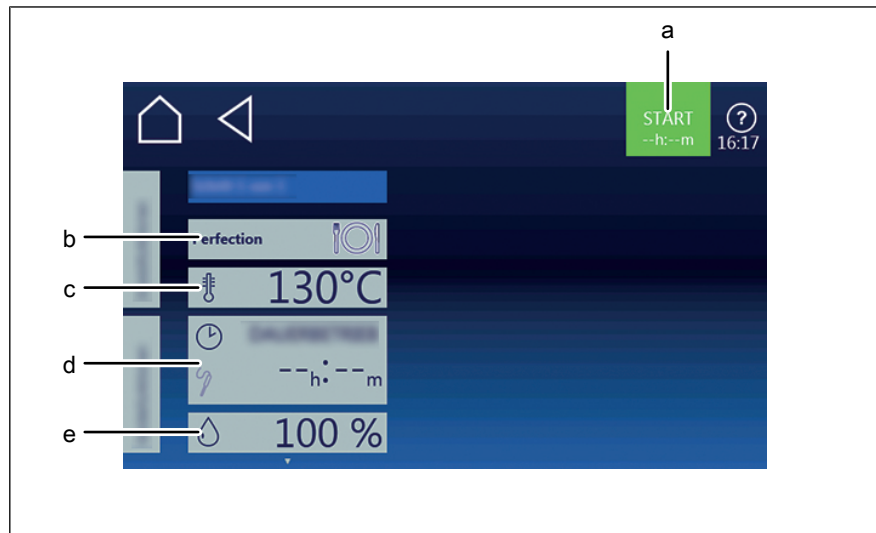

Image: "Perfection" cooking mode setting window

- | | |
|-----------------------------|-----------------------------|
| a "Start" button | d <i>Cooking time</i> field |
| b <i>Cooking mode</i> field | e <i>Moisture</i> field |
| c <i>Temperature</i> field | |

Starting Perfection

- Prerequisite** Food to be cooked in the insert on the shelf
 Door closed
Manual cooking menu displayed

1. Tap the *Perfection* mode field.
 - ↳ The *Cooking mode* window is displayed.
 2. Configure the settings.
 - ↳ The *Cooking mode* window shows the configured settings.
 3. Tap the "Start" button in the information strip.
 - ↳ The unit heats up.
 - ↳ The "Start" button is replaced with the "Stopp" button.
 - ↳ The cooking time is updated in the *Cooking mode* window.
- ↳ Perfection is started.

Ending Perfection

Prerequisite Perfection started
Cooking time has not expired

1. Tap the "Stopp" button in the information strip.
- or
2. Wait until the cooking time ends.
 - ↳ Heating of the unit is ended.
 - ↳ The "Stopp" button is replaced with the "Start" button.
 - ↳ The cooking time is reset.
- ↳ Perfection is ended.

4.6.7 Using PerfectHold

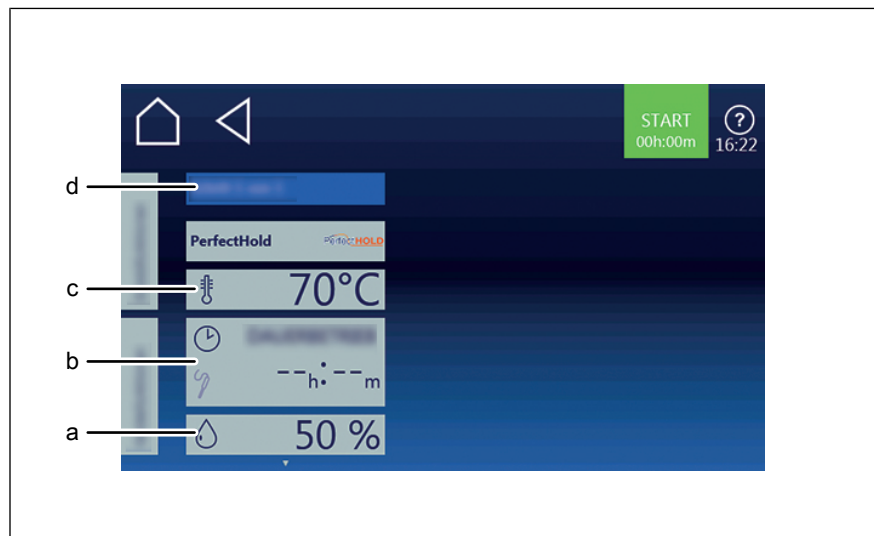

Image: PerfectHOLD setting window

- | | | | |
|---|--------------------|---|-------------------|
| a | Moisture button | c | Temperature field |
| b | Cooking time field | d | Setting window |

Prerequisite Cooking program has ended
Manual cooking menu open
Advanced cooking function selected

1. Tap the *Temperature* field.
2. Using a swipe gesture, set the rollers to the desired temperature.
3. Tap the *Confirm* button.
 - ↳ The *Setting* window closes.
4. Tap the *Cooking time* field.
 - ↳ The *Setting* window is displayed.
5. Tap the *Cooking time* button.
6. Using a swipe gesture, set the rollers to the desired temperature.
 - ↳ Swipe up / down to increase / decrease the cooking time.

7. Tap the *Confirm* button.
 - ↳ The *Setting* window closes.
 - ↳ The *Cooking mode* window displays the set cooking time.
- ↳ PerfectHOLD is set for time control.

4.6.8 Ready2CookSetting

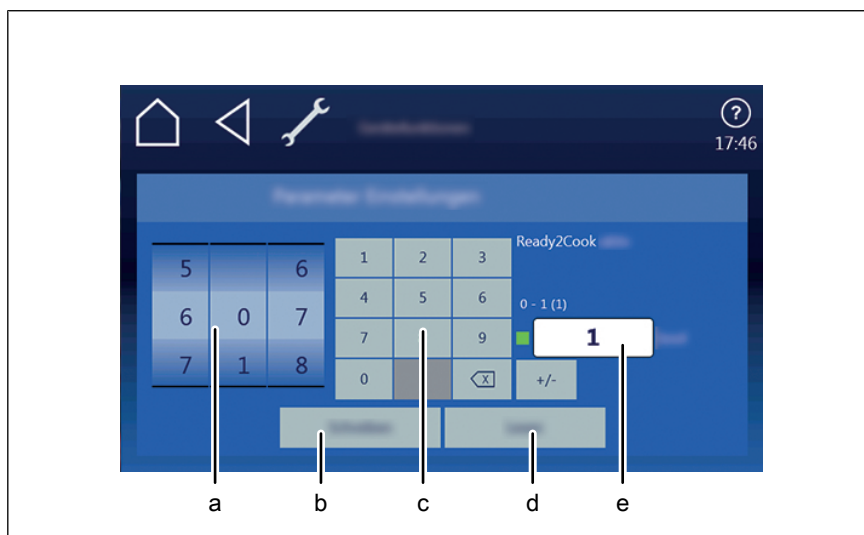

Image: Window for setting the "Ready2Cook" parameters

- | | | | |
|---|-----------------|---|-------------|
| a | Rollers | d | Read button |
| b | Write button | e | Display |
| c | Keyboard button | | |

Prerequisite *Unit function* menu open

1. Tap the *Settings* field.
2. Enter PIN 111 and confirm it.
3. Tap the *Parameter settings* field.
 - ↳ The *Parameter settings* menu is displayed.
4. Use a swipe gesture to set the rollers to the desired value.
 - ↳ The name of the selected parameter is displayed.
5. Tap the *Read* button.
 - ↳ The current values displayed.
 - ↳ Switch the function on or off as necessary.
6. Use the keyboard to delete the current value.
7. Use the keyboard to enter a new value.
8. Tap the *Write* button.
 - ↳ The displayed value is adopted.
- ↳ The *Ready2Cook* function is set.

4.6.9 Steam Exhaust System Using the (SES)

INFORMATION

The *Steam Exhaust System (SES)* automatically extracts the steam out of the cooking chamber.

It is on by default and can be switched off for individual programs.

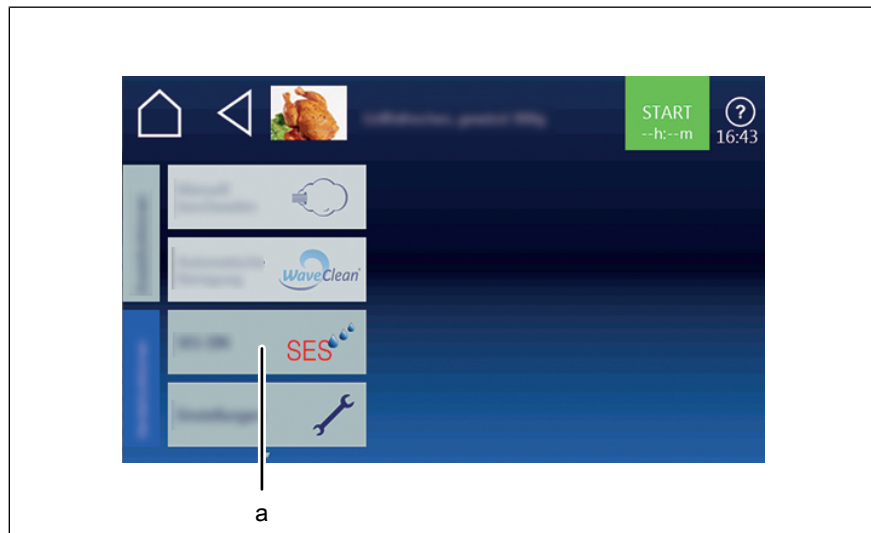

Image: Window for selecting the Steam Exhaust System (SES)

a *Steam Exhaust System* field

Prerequisite *ChefsHelp* information step created

1. Tap on Additional function.
2. Tap the *SES* field.

↳ The "ON" display switches automatically to "OFF" and vice versa.

↳ The *SES* function is set.

4.6.10 RackControl Using 2

INFORMATION

Set parameters such as the cooking time or core temperature can be changed for selected shelves during the cooking process. The cooking process is not interrupted.

Parameters such as the cooking chamber humidity, cooking chamber temperature and fan speed can be accessed and set.

These changes apply only to the currently running cooking program and are not retained as presets.

RackControlSetting and starting 2

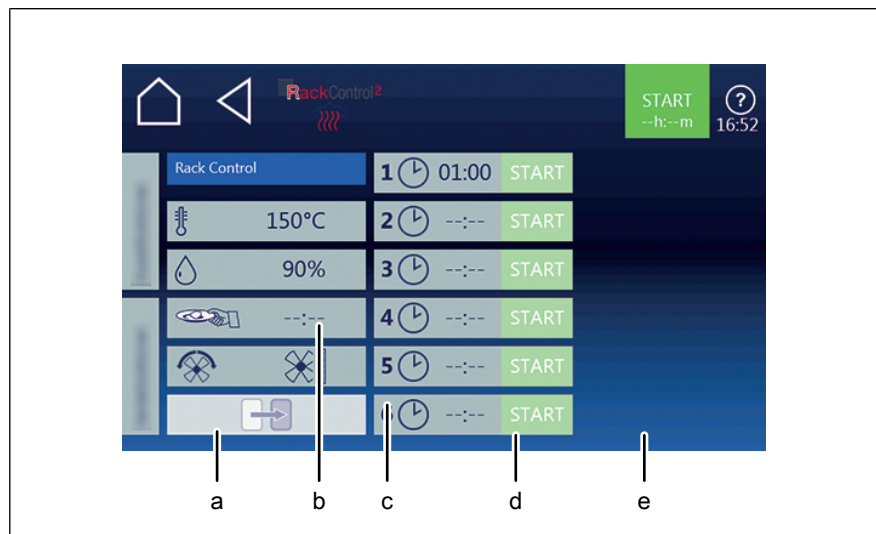

Image: RackControl2 cooking time setting window

- | | | | |
|---|-------------------|---|-------------------|
| a | Settings field | d | Start time button |
| b | Shelf field | e | Confirm button |
| c | Start time window | | |

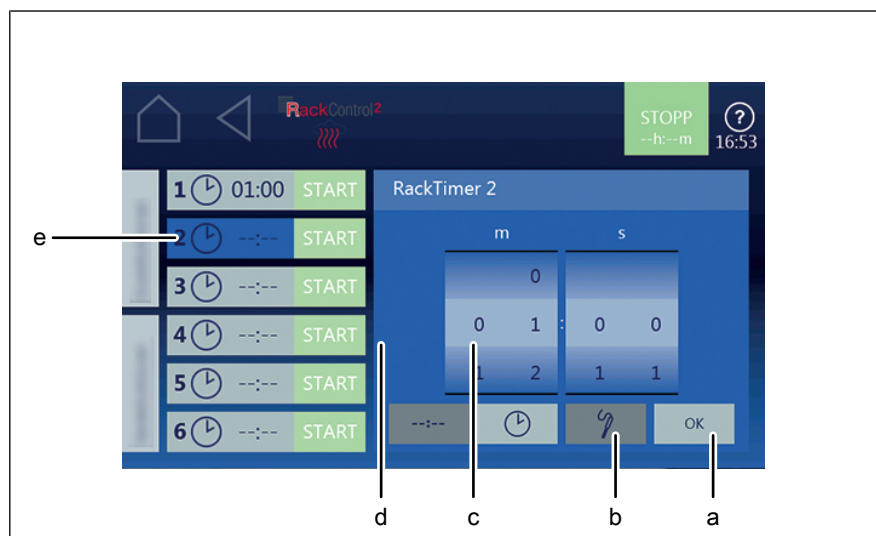

Image: RackControl2 core temperature setting window

- | | | | |
|---|-------------------------|---|------------------|
| a | Confirm button | d | Settings field |
| b | Core temperature button | e | Start time field |
| c | Rollers | | |

Prerequisite *Manual cooking* field is selected

1. Tap the *RackControl2* field.
2. Tap the *Cooking mode* field.
3. Tap the *Settings* field.
4. Swipe upwards to open the next page.
 - ↳ The next page with the *Fan setting* field is displayed.
5. Configure the fan settings as necessary.

6. Select the desired shelf.
 7. Configure and confirm the desired settings (See "Setting the cooking time" and "Setting the core temperature").
 - ↳ RackControl2 is set for the selected shelf.
 8. Configure settings for additional shelves as necessary.
 9. Tap the "Start" button in the information strip.
 - ↳ The display changes to the "Actual value" display.
 - ↳ The unit heats up.
 - ↳ The "Start" button is replaced with the "Stopp" button.
- ↳ RackControl2 is started.

RackControlEnding 2



Image: End RackControl2 early window

a Stop button

b Setting window

Prerequisite RackControl2 is started

Preheat temperature not reached

1. Tap the *RackControl2* window.
 - ↳ The last *Setting* window is displayed.
 2. Swipe upwards to open the next page.
 3. Tap the *Continue* field.
 - ↳ Heating is interrupted.
- ↳ RackControl2 starts at the current temperature.

4.6.11 Time2ServeSetting

INFORMATION

The cooking time can be set for up to 23 hours and 59 minutes in 1-minute increments.

Continuous operation is stopped automatically after 23 hours and 59 minutes.

The hours and minutes appear in the display.

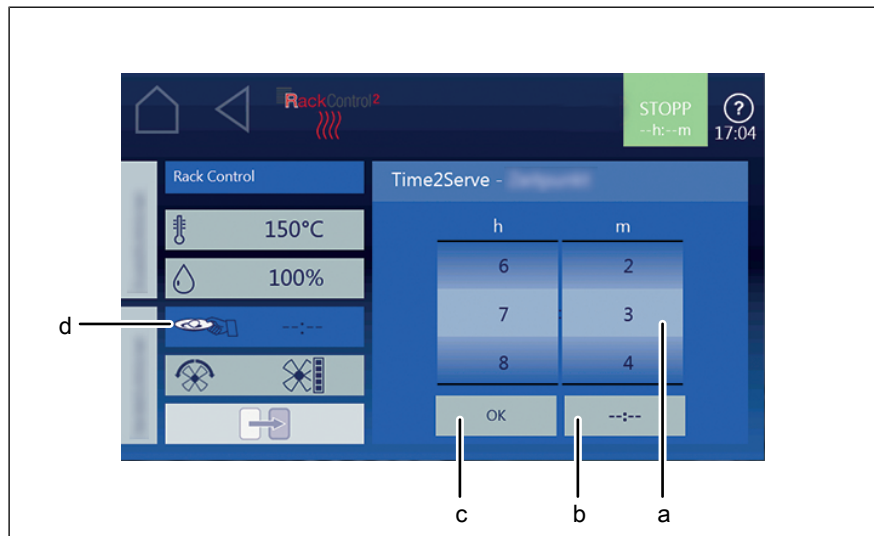

Image: Time2Serve cooking time setting window

- | | |
|-------------------------------|--------------------|
| a Rollers | c OK button |
| b Continuous operation button | d Time2Serve field |

1. Tap the *RackControl2* field.
2. Tap the *Cooking time* field.
3. Tap the *Time2Serve* field.
4. Use a swipe gesture to set the desired time.
 - ↳ Time2Serve is set.
5. Make the settings for the RackTimer and confirm them (see "Using RackControl2").
 - ↳ RackControl2 for the selected shelf is set.
6. Make the settings for additional shelves as necessary.
7. Tap the "Start" button in the information strip.
 - ↳ The display changes to "Current display".
 - ↳ The unit heats up.
 - ↳ The "Start" button is replaced with the "Stop" button.
- ↳ Time2Serve starts.
- ↳ RackControl2 starts.

4.6.12 FamilyMixUsing

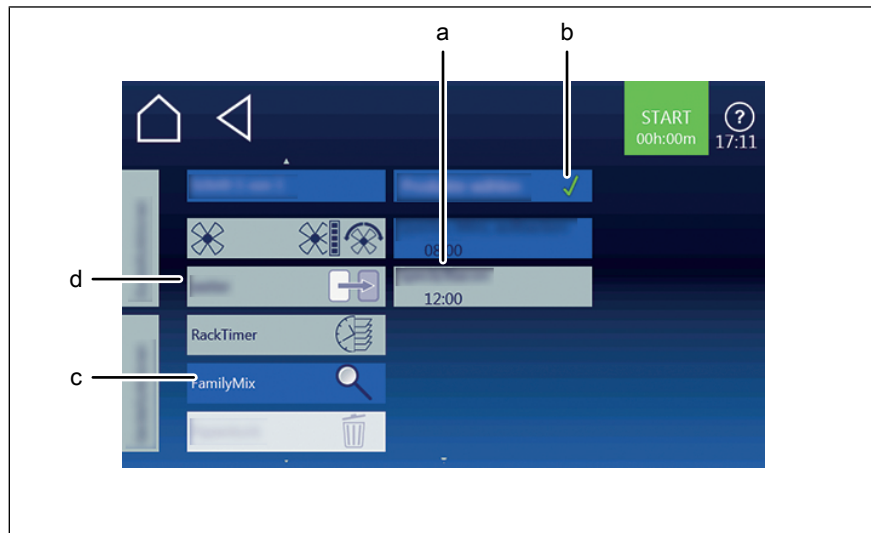

Image: FamilyMix selection window

- | | | | |
|---|------------------------|---|-----------------|
| a | Product overview field | c | FamilyMix field |
| b | Product field | d | Settings field |

Prerequisite *Manual cooking* field is selected

Cooking program loaded

1. Tap the *Settings* field.
 2. Tap the *FamilyMix* field.
 3. Tap the *Product overview* field and select product.
 - ↳ Tap the *Product* field: The product is selected.
 - ↳ Tap the *Product* field again: Product selection is canceled.
 4. Tap the "Start" button.
 - ↳ The display changes to "Ready2Cook".
 - ↳ The unit heats up.
 - ↳ The "Start" button is replaced with the "Stopp" button.
 5. Wait until the cooking time ends.
 - ↳ Heating of the unit is ended.
 - ↳ The "Stopp" button is replaced with the "Start" button.
 - ↳ The cooking time is reset.
- ↳ The *FamilyMix* function is set.

4.6.13 Using continue cooking

INFORMATION

When selecting products with different preset cooking times, the cooking time for selected products can be extended on an individual basis.

INFORMATION

Continue cooking can be set for up to 5 minutes in 1-minute increments.

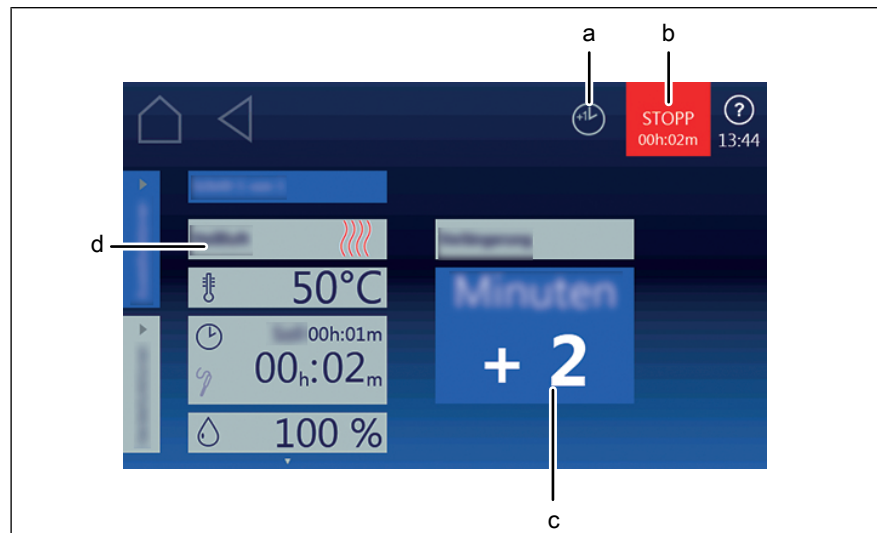

Image: Cooking time extension selection window

- | | | | |
|---|--------------------------------|---|-------------------------------|
| a | <i>Continue cooking</i> button | c | <i>Continue cooking</i> field |
| b | Stop button | d | Settings field |

Prerequisite

Cooking program selected

The *RackTimer* function is set

1. Tap the "Start" button.
 - ↳ The unit heats up.
 - ↳ The cooking program starts.
 - ↳ The "Start" button is replaced with the "Stopp" button.
2. Press the "Stop" button.
 - ↳ The cooking program is interrupted.
 - ↳ The "Continue cooking" button appears in the information strip.
3. Tap the "Continue cooking" button.
4. Since the desired time for continued cooking.
 - ↳ The cooking time is increased in 1-minute increments.
 - ↳ The modified cooking time applies only to the current cooking program.
 - ↳ It does not change the saved cooking program.
 - ↳ The *Continue cooking* function is set.

5. Tap the "Start" button.
 - ↳ The cooking program starts.
 - ↳ The cooking time is extended by the desired time.
 - ↳ The *Continue cooking* function is running.

4.6.14 Setting manual steaming

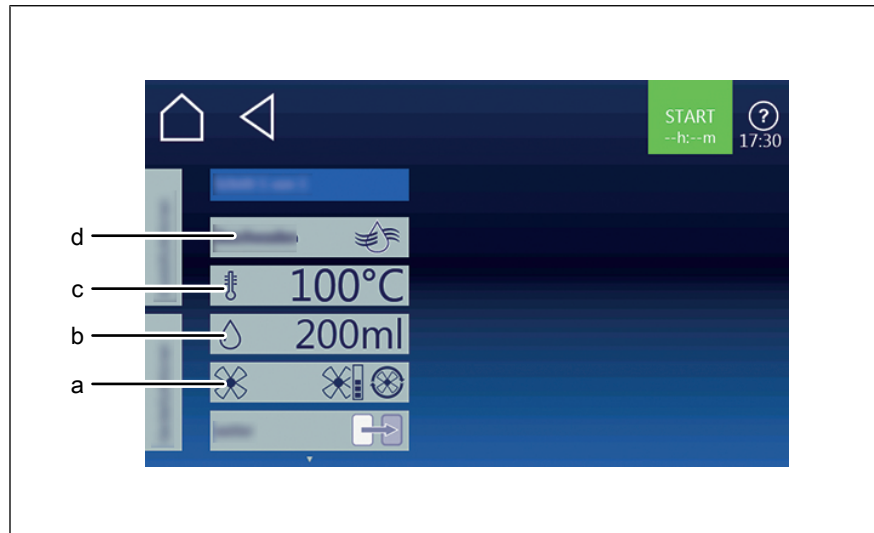

Image: *Manual steaming setting window*

- | | | | |
|---|----------------------|---|-----------------------|
| a | Fan setting field | c | Temperature field |
| b | Moisture level field | d | Manual steaming field |

Prerequisite The cooking program is running

1. Tap the *Unit functions* field.
 - ↳ *Unit functions* menu open.
 2. Tap the *Manual steaming* field.
 - ↳ *Manual steaming* menu open.
 3. Using a swipe gesture, set the rollers to the desired temperature.
 - ↳ Swipe up / down to increase / decrease the cooking temperature.
 4. Tap the *OK* button.
 - ↳ The *Setting* window closes.
 5. Tap the *Desired injection quantity* field.
 - ↳ The *Setting* window is displayed.
 6. Using a swipe gesture, set the rollers to the desired temperature.
 - ↳ Swipe up / down to increase / decrease the desired injection amount.
 7. Tap the *Confirm* button.
 - ↳ The *Setting* window closes.
- ↳ Manual steaming is set.

4.6.15 Setting a resting step

INFORMATION

The *Add resting step* function is available at any time.

Unless saved, the step applies only to the current cooking program.

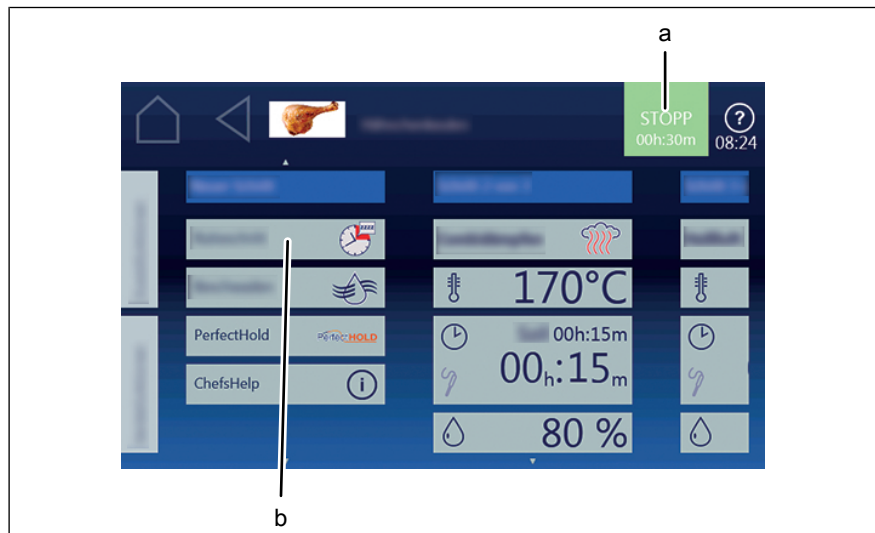

Image: *Insert rest step* window

a *Start* button

b *Rest step* field

Prerequisite *Automatic cooking* menu open
Cooking program selected

1. Select the *New step* function.
2. Tap the *Resting step* field.
 - ↳ The *Manual cooking* menu appears.
3. Configure the settings.
 - ↳ Set the cooking mode.
 - ↳ Set the temperature.
 - ↳ Set the time.
 - ↳ Set the moisture.
4. Tap the "Start" button.
 - ↳ The *Resting step* is added to the current program.
 - ↳ The *Resting step* is not saved in the cooking program.
5. Save the cooking program.
 - ↳ The *Resting step* is saved in the cooking program.

4.6.16 QualityControlUsing

INFORMATION

QualityControl is an automatic cooking time optimization function based on automatic temperature adjustment. It optimizes the preheating process.

It is on by default and can be switched off for individual programs.

INFORMATION

The current setting applies to all cooking programs until changed.

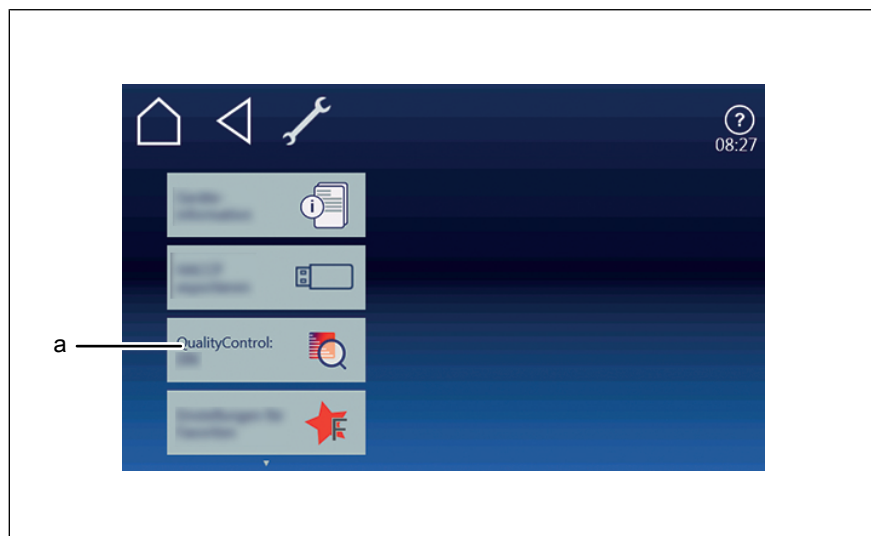

Image: Window for selecting QualityControl

a fieldQualityControl

Prerequisite *Unit functions* menu open

1. Tap the "Settings" field.
2. Enter PIN 111 and confirm it.
 - ↳ The *QualityControl* field is displayed.
3. Switch the function on or off as necessary.
4. Tap the *QualityControl* field.
 - ↳ The *ON* display automatically changes to *OFF* and vice versa.
 - ↳ The *QualityControl* function is set.

4.6.17 Using LT cooking

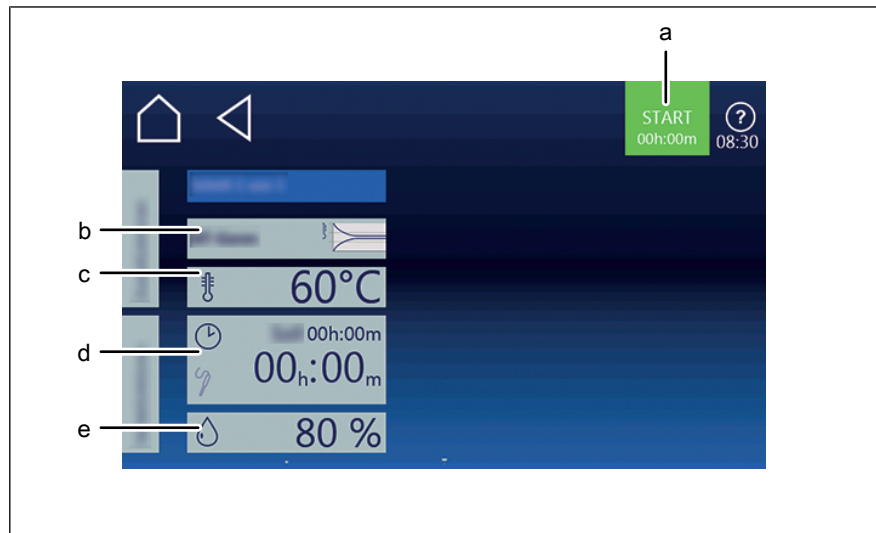

Image: *LT cooking mode setting window*

- | | |
|---|-----------------------------|
| a "Start" button | d <i>Cooking time</i> field |
| b <i>Cooking mode</i> field | e <i>Moisture</i> field |
| c <i>Cooking temperature difference</i> field | |

Starting LT cooking

Prerequisite Food to be cooked on insert in shelf

Core temperature sensor set

Door closed

Manual cooking menu displayed

1. Tap the "LT cooking" mode field.
 - ↳ The "Cooking mode" window is displayed.
 2. Make the settings.
 - ↳ The "Cooking mode" window shows the settings made.
 3. Tap the "Start" button in the information strip.
 - ↳ The unit heats up.
 - ↳ The "Start" button is replaced with the "Stop" button.
 - ↳ The cooking time in the "Cooking mode" window is updated.
- ↳ LT cooking starts.

Ending LT cooking

Prerequisite LT cooking started

Cooking time has not expired

1. Tap the "Stop" button in the information strip.

or

2. Wait until the cooking time ends.
 - ↳ Heating of the unit is ended.
 - ↳ The "Stopp" button is replaced with the "Start" button.
 - ↳ The cooking time is reset.
- ↳ LT cooking is ended.

4.6.18 Using Delta-T cooking

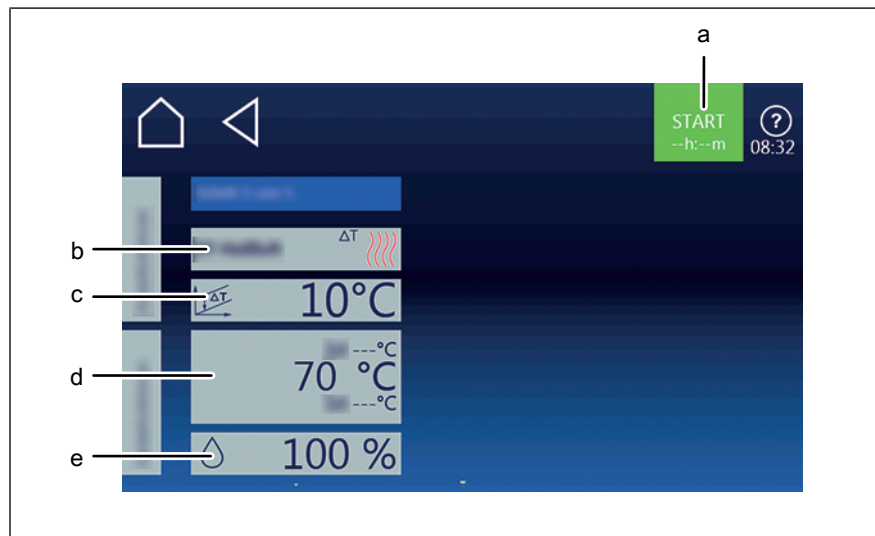

Image: *Delta-T cooking mode setting window*

- | | | | |
|---|--------------------------------------|---|------------------------|
| a | "Start" button | d | Core temperature field |
| b | Cooking mode field | e | Moisture field |
| c | Cooking temperature difference field | | |

Starting Delta-T cooking

- Prerequisite** Food to be cooked on insert in shelf
Core temperature sensor set
Door closed
Manual cooking menu displayed

1. Tap the "Delta-T cooking" mode window.
 - ↳ The "Cooking mode" window is displayed.
2. Make the settings.
 - ↳ The "Cooking mode" window shows the settings made.
3. Tap the "Start" button in the information strip.
 - ↳ The unit heats up.
 - ↳ The "Start" button is replaced with the "Stop" button.
 - ↳ The cooking time in the "Cooking mode" window is updated.
- ↳ Delta-T cooking starts.

Ending Delta-T cooking

Prerequisite Delta-T cooking started
Cooking time has not expired

1. Tap the "Stopp" button in the information strip.
- or
2. Wait until the cooking time ends.
 - ↳ Heating of the unit is ended.
 - ↳ The "Stopp" button is replaced with the "Start" button.
 - ↳ The cooking time is reset.
- ↳ Delta-T cooking is ended.

4.6.19 Using the barcode scanner

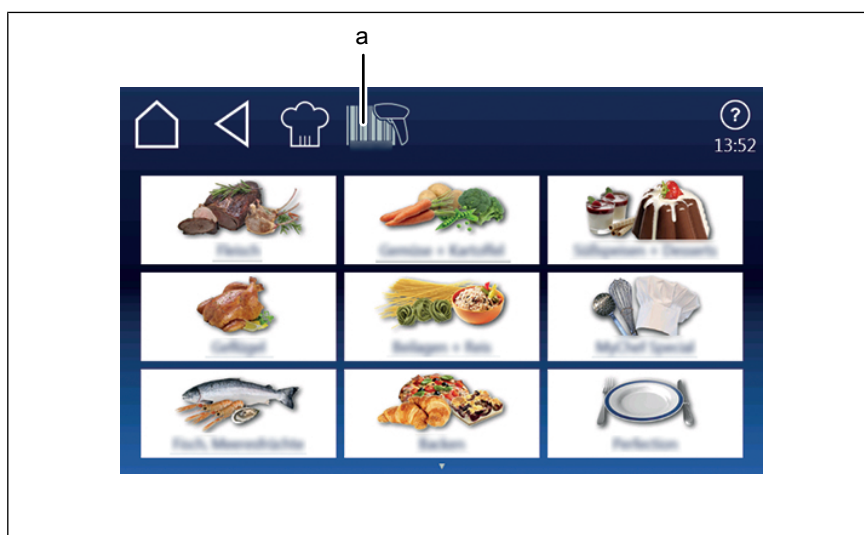

Image: Barcode scanner selection window

a Barcode scanner button

Prerequisite Barcode scanner connected

1. Tap the *Barcode scanner* button.
 2. Read the barcode.
 - ↳ The product is located.
 - ↳ The cooking program is loaded.
- ↳ The *Barcode scanner* function is used.

4.6.20 Inserting and removing the USB stick

Inserting the USB stick

Prerequisite USB stick with a minimum of 2 GB and maximum of 32 GB available storage capacity (not included with delivery)
USB stick not write-protected

→ Insert the USB flash drive.

↳ The USB stick is ready after at most 20 seconds.

Removing the USB stick

Prerequisite Exporting or importing of data completed

→ Remove the USB stick.

4.6.21 Preparing a USB stick for importing and exporting

Prerequisite USB stick is formatted
USB stick not write-protected

1. Create a folder structure for importing and exporting.
 2. Create a folder with the name "autoChefImages".
↳ Data exchange of photos in PNG format, resolution 249x111 pixels.
 3. Create a folder with the name "FCBrowserFiles".
↳ Data exchange of texts in HTML format.
 4. Create a folder with the name "FCImport".
↳ Data exchange of cookbooks.
 5. Create a folder with the name "MMIContent".
↳ Data exchange of additional imported content.
 6. Create a folder with the name "MMiUpdate".
↳ Data exchange of update files.
- ↳ Once the folder structure has been created, the USB stick is ready for use.

4.6.22 Exporting the HACCP log

Prerequisite USB stick inserted
Logged in with password under "Unit settings"

1. Tap the "Export HACCP" field.

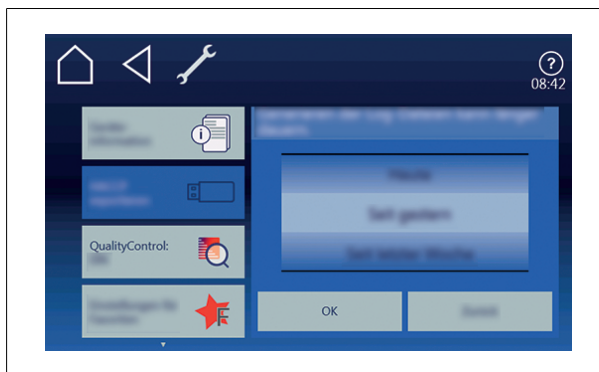

2. Select the time period for the records.
3. Tap the *OK* button.
 - ↳ The *Operating instructions* window opens.
4. Tap the *OK* button.
 - ↳ The HACCP record is exported to the USB stick.
 - ↳ The *OK* window opens.
5. Tap the *Confirm* button.
 - ↳ The *Confirm* window closes.

INFORMATION

The HACCP log can also be transferred via a kitchen guiding system.

4.7 Using the core temperature sensor

WARNING

Risk of injury from a bursting core temperature sensor

- The core temperature sensor can burst as the result of overheating of the measuring tip.
- Never heat the core temperature sensor with an open flame or other heat sources.

CAUTION

Risk of burns from hot surfaces

- Grasp the core temperature sensor by the handle, remove it from the cooked food and carefully place it into the holder.
- Protect arms and hands by wearing suitable protective gloves.

INFORMATION

A core temperature measurement is always possible, if the core temperature sensor is inserted in the food being cooked. Also before or after a cooking process or during a time-controlled cooking step.

INFORMATION

Measuring the core temperature is recommended for all types of cooking to achieve an optimal result.

4.7.1 Measuring with a 4-point core temperature sensor

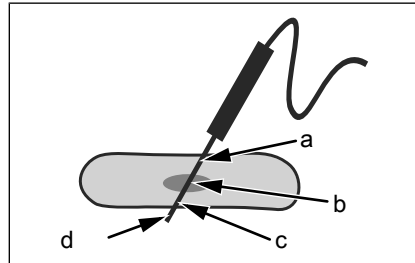

Image: Core temperature sensor with four measuring points

- Insert the core temperature sensor fully into the food to be cooked.
- Insert the core temperature sensor into the thickest section of the food to be cooked.
- When cooking food with a bone, insert the core temperature sensor close to the bone.
- When cooking longer pieces of food, insert the core temperature sensor across the food to avoid a hole in the center of the slice.
- When cooking fowl, insert the core temperature sensor into the inside of the leg.

4.7.2 Measuring the core temperature when cooking frozen food

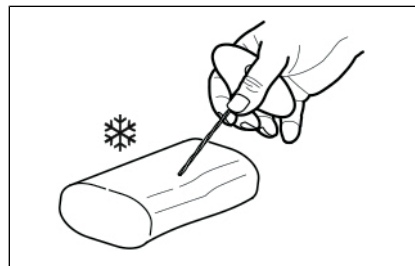
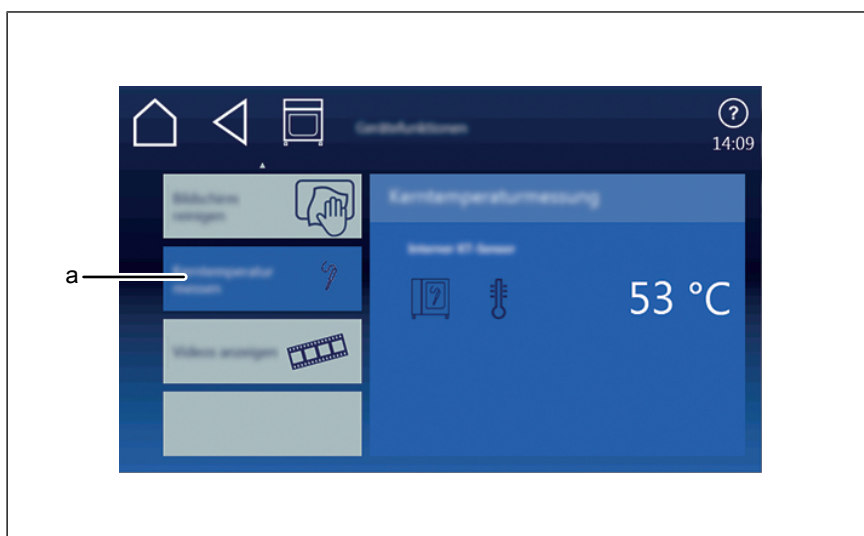

Image: Drilling an insertion duct with a hand drill

1. Use a hand drill to make an insertion duct for inserting the sensor.
2. Place the food to be cooked on the baking sheet or into the cooking pan.
3. Place the cooking sheet or cooking pan into the unit.
4. Insert the core temperature sensor into the food to be cooked.

4.7.3 Core temperature display with time-controlled cooking process



a Core temperature button

b Core temperature display

Prerequisite Core temperature sensor in the food being cooked
Time-controlled cooking process is running

1. Tap the *Core temperature* button in the cooking step display.
↳ The current core temperature is displayed for 5 seconds.

4.7.4 Core temperature display outside the cooking process

Prerequisite Core temperature sensor inserted into the food to be cooked

1. Open the *Unit functions* menu.



2. On the second page, tap the "Measure core temperature" button.
↳ The core temperature is displayed.

4.8 Manual cooking (myCooking)

Cooking modes and other functions are available in the Manual cooking mode. Selecting one of the components automatically creates a single-step cooking program.

Settings such as cooking mode, cooking temperature and cooking time are specified, and the cooking step is either started or saved.

4.8.1 Opening the Manual cooking menu

Prerequisite Unit is on
The Main menu is displayed

- Tap the "Manual cooking" button.
- ↳ The *Manual cooking* menu is displayed.

4.8.2 Creating a cooking program step

Prerequisite Unit switched on
The *Manual cooking* menu is displayed
Cooking mode is selected

1. Tap the *Cooking temperature* field.
- ↳ The *Setting* window is displayed.



2. Use a swipe gesture to set the rollers to the desired value.
3. Tap the *OK* button.
- ↳ The *Setting* window closes.
4. Tap the *Cooking time* field.
- ↳ The *Setting* window is displayed.

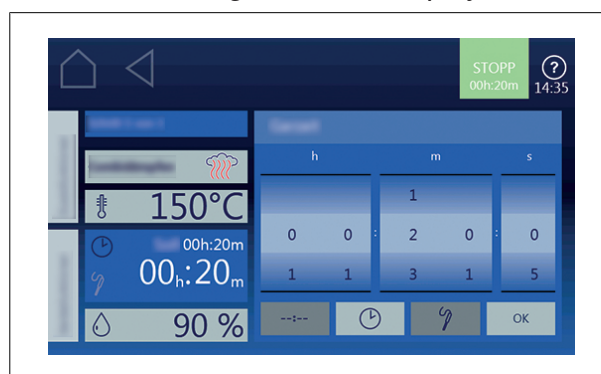

5. Tap the *Continuous operation* button or *Cooking time* button or *Core temperature* button.
6. Use a swipe gesture to set the rollers to the desired value.
7. Tap the *OK* button.
- ↳ The *Setting* window closes.
8. Tap "Cooking chamber moisture".
- ↳ The *Setting* window is displayed.

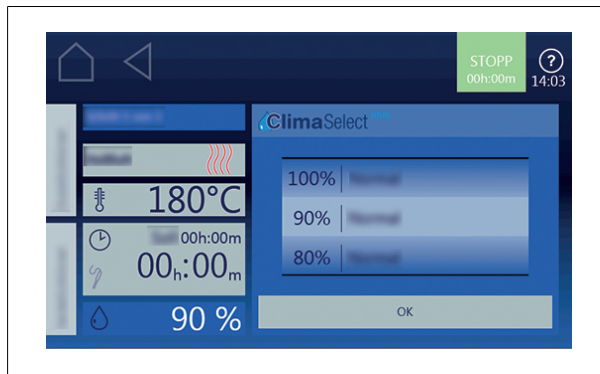

9. Use a swipe gesture to set the roller to the desired value.
10. Tap the *OK* button.

↳ The *Setting* window closes.

11. Use a swipe gesture to change to the next page and make additional settings.

12. Tap the *Fan* field.

↳ The *Setting* window is displayed.



13. Set the fan speed and direction of rotation.
14. Use a swipe gesture to set the rollers to the desired value.
15. Tap the *OK* button.

↳ The *Setting* window closes.

↳ The cooking program step can be started.

Tip

The cooking mode can also be changed while entering the cooking step.

- Tap the *Cooking mode* field.

⇒ Possible selections appear.

- Tap the new cooking mode.

⇒ The standard values of the selected cooking mode are displayed.

- Modify the values.

⇒ Cooking mode for this cooking step is changed.

4.9 Creating and managing your own cooking programs

Cooking modes and other functions are available in the *Manual cooking* menu. Using these components, users can create their own programs.

NOTICE

Risk of property damage from data loss

Save your own cooking programs to an external storage device, e.g. a USB stick, regularly.

4.9.1 Creating a cooking program

Creating a cooking program step

Prerequisite *Manual cooking* menu displayed

1. Tap the field for the desired cooking mode.
 - ↳ The first step of the cooking program is created.
 - ↳ The cooking step displayed reads "Step 1 of 1".
2. Modify the desired settings for the first step.
 - ↳ The first step of the cooking program has been created.

Adding a cooking program step

1. Swipe up to open the next page.
 - ↳ The next page is displayed.

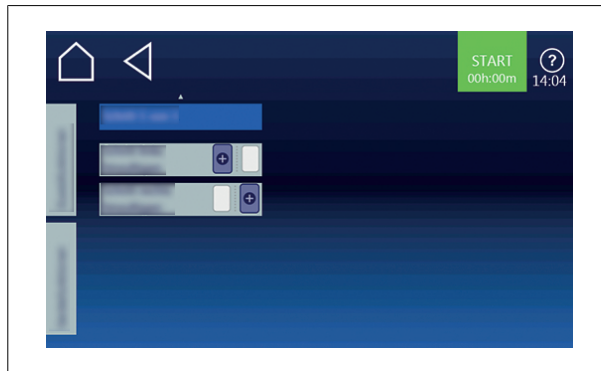

2. Tap the "Add a preceding step" field.
or
3. Tap the "Add a following step" field.
 - ↳ The "New step" window opens.
4. Tap the cooking mode or function in the window to select it.
 - ↳ The cooking step displayed in the window shows the current position of the new step in the cooking program.
5. Modify the settings for the step.
 - ↳ The new step is added.

Deleting a cooking program step

INFORMATION

If a cooking program has only one step, it cannot be deleted. The function is not active.

1. Select the step.
2. A swipe gesture upward opens the next page.
 - ↳ The next page for the step is displayed.
3. Tap the "Delete step" field.
 - ↳ The *Delete* window is displayed.
4. Tap the "Yes" button.
 - ↳ This deletes the step.
 - ↳ The positions of the remaining steps in the cooking program are updated.
 - ↳ The step is deleted.



4.9.2 Saving the cooking program

NOTICE

Risk of property damage from data loss

Save your own cooking programs to an external storage device, e.g. a USB stick, regularly.

INFORMATION

Cooking programs that have been created can be saved prior to starting or after completion of the cooking program.

INFORMATION

To save a cooking program, at least one cooking program name and one category must be specified.

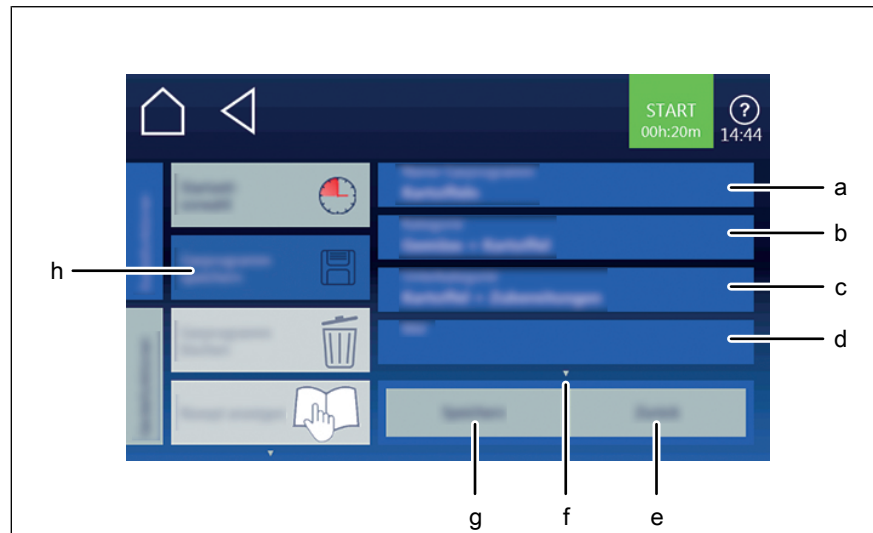

Image: Saving the cooking program in the window

- | | |
|--------------------------------|--------------------------------|
| a "Cooking program name" field | e "Back" button |
| b "Category" field | f "Next page" arrow symbol |
| c "Subcategory" field | g "Save" button |
| d "Image" field | h "Save cooking program" field |

Prerequisite Cooking program created and displayed

1. Tap the *Additional functions* tab.
 - ↳ The *Tab* window is open.
2. Tap the "Save cooking program" field.
 - ↳ The *Save* window is open.
- ↳ Save after making the entries.

Saving the cooking program name

1. Tap the "Cooking program name" field.
 - ↳ The *Keyboard* menu is displayed.
2. Use the keys to enter the desired program name.
3. Tap the *OK* button.
 - ↳ The *Keyboard* menu closes.
 - ↳ The program name is displayed in the *Save* window.

Entering a category

1. Tap the "Category" field.
 - ↳ The *Automatic cooking* menu is displayed.
2. Tap the field for the desired *Category*.
 - ↳ The category is set.
 - ↳ The *Automatic cooking* menu closes.
 - ↳ The category is displayed in the *Save* window.

Entering a subcategory (optional)

1. Tap the "Subcategory" field.
 - ↳ The *Subcategory* menu is displayed.
2. Tap the field with the desired *Subcategory*.
 - ↳ The subcategory is set.
 - ↳ The *Subcategory* menu closes.
 - ↳ The subcategory is displayed in the *Save* window.

Assigning an image (optional)

1. Tap the "Image" field.
 - ↳ The *Image* menu is displayed.
 - ↳ Images stored in the unit are displayed.
 2. Select image by tapping on it.
 - ↳ The *Image* menu closes.
 - ↳ The name of the image is displayed in the *Save* window.
- ↳ Selected image is assigned to the cooking program.

INFORMATION

If the desired image is not stored in the unit, it can be loaded from a USB stick.

Preparation:

Create a folder named "autoChefImages" on the USB stick.

Save image in PNG format, resolution 249x111 pixels in this folder.

3. Insert the USB flash drive.
 - ↳ The USB stick is ready after at most 20 seconds.
 4. Tap the "Image" field.
 - ↳ The *Image* menu is displayed.
 - ↳ Images stored in the unit are displayed.
 5. Tap the "Pictures on USB stick" button.
 - ↳ The images stored on the USB flash drive are displayed.
 6. Select image by tapping on it.
 - ↳ The *Image* menu closes.
 - ↳ Image saved on the unit.
 - ↳ The name of the image is displayed in the *Save* window.
- ↳ Selected image is stored in the unit and assigned to the cooking program.

Assigning a video (optional)

1. Tap the "Video" field.
 - ↳ The *Video* menu is displayed.
2. Select the video by tapping it.
3. Select the location to save the photo.

4. Tap the button for "Videos in unit" or "Videos on USB stick".
 - ↳ Video is selected.
 - ↳ The *Video* menu is closed.
 - ↳ The name of the video is displayed in the Save window.

Assigning a recipe (optional)

1. Tap the "Recipe" field.
 - ↳ The *Recipe* menu is displayed.
2. Tap the "Empty recipe" field.
3. Select the save location.
4. Tap the "Recipes in unit" button or the "Recipes on USB stick" button.
 - ↳ The recipe is set.
 - ↳ The *Recipe* menu closes.
 - ↳ The name of the recipe is displayed in the *Save* window.

Selecting favorites (optional)

1. Tap the "Show favorites" field.
 - ↳ The *Show favorites* menu is displayed.
2. Tap the "Yes" button or the "No" button.
 - ↳ Tapping Yes displays the cooking program in the Favorites menu.

Selecting characteristics of the food to be cooked (optional)

1. Tap the "Frozen food" field.
 - ↳ The *Frozen food* menu is displayed.
2. Tap the "Yes" button or the "No" button.
 - ↳ Tapping Yes selects the food to be cooked as a frozen food.

Assigning an identification (optional)

1. Tap the "Identification" field.
 - ↳ The *Identification* menu is displayed.
 2. Use the keyboard to enter the barcode.
- or
3. Read the barcode with the barcode scanner.
 - ↳ Scan the barcode and assign to a cooking program or to food to be cooked.

Selecting QualityControl

1. Tap the "QualityControl" field.
 - ↳ The *QualityControl* menu is displayed.
2. Tap the "No" button.
 - ↳ QualityControl is deactivated for the cooking program.

3. Tap the "Yes" button.
 - ↳ Tapping Yes sets the cooking program for a minimal amount of food to be cooked.
 - ↳ QualityControl automatically adjusts the cooking time for a larger charge.

4.9.3 Exporting a cooking program

INFORMATION

Previously exported cooking programs on the USB stick will be overwritten.

Prerequisite Cooking program open
 Cooking program saved
 USB stick inserted

1. Tap the *Additional functions* tab.
 - ↳ The *Tab* window is open.
2. Tap the "Export cooking programs" field.
 - ↳ The *Operating instructions* window opens.



3. Read the operating instructions displayed.
 4. Tap the *OK* button.
 - ↳ The cooking program is exported to the USB stick.
 - ↳ The *OK* window is displayed.
 5. Tap the *OK* button.
 - ↳ The *Additional functions* tab closes.
- ↳ The cooking program is exported.

4.10 Automatic cooking (autoChef)

In the "Automatic cooking" mode, all cooking programs stored in the unit are available. The cooking program is selected in the *Automatic cooking* menu.

4.10.1 Opening the Automatic cooking menu

Prerequisite Unit switched on
Main menu displayed

→ Tap the "autoChef" button.

↳ The *Automatic cooking* menu is displayed.

4.10.2 Finding and opening a cooking program

Finding and opening a cooking program by category

Cooking programs can be found by categories and subcategories in the *Automatic cooking* menu.

INFORMATION

Arrow symbols in a window always display the next or previous page. A swipe gesture upward or downward opens the corresponding window.

Prerequisite Unit switched on
Main menu displayed

1. Tap the "autoChef" button.

↳ The *Automatic cooking* menu is displayed.

2. Tap the field for the desired category.

↳ The subcategory menu is displayed.

3. Tap the field for the desired subcategory.

↳ The recipe menu containing all recipes in the subcategory is displayed.

4. Tap the field for the desired recipe.

↳ The cooking program is selected and being loaded.

↳ The cooking program steps are displayed.

↳ The cooking program is open.

Finding and opening a cooking program in the cookbook

All cooking programs are saved in alphabetical order in the cookbook.



Image: Find cooking program window

a autoChef button

Prerequisite Unit switched on
Main menu displayed

1. Tap the "autoChef" button.
 - ↳ The category menu is displayed.
 2. Tap the "autoChef" button in the information strip.
 - ↳ The *autoChef* window is displayed.
 3. Tap the *Find cooking program* field.
 - ↳ The *Search* window is displayed.
 4. Enter the letters of the name you are seeking on the keyboard.
 - ↳ A filtered list appears in the *Result* display.
 5. Tap the field with the name you are seeking.
 - ↳ The cooking program is selected and being loaded.
 - ↳ The cooking program steps are displayed.
- ↳ The cooking program is open.



4.10.3 Starting the cooking program

INFORMATION

The current step in the cooking program is highlighted. Upon completion, the following step automatically appears in the display.

Prerequisite Cooking program open

1. Tap the "Start" button in the information strip.
 - ↳ The cooking program starts.
 - ↳ The "Start" button in the information strip changes to the "Stopp" button
 - ↳ The remaining cooking program time is displayed in the "Stopp" button.
- ↳ The cooking program is started.

4.10.4 Ending the cooking program

Prerequisite Cooking program started
Cooking program time has not elapsed

1. Tap the "Stopp" button in the information strip.
or
2. Wait for the cooking time to end.
 - ↳ Cooking program has ended.
 - ↳ The "Stopp" button in the information strip changes to the "Start" button
- ↳ The cooking program has ended.

INFORMATION

If the cooking chamber door is not opened, the fan continues to run at a low speed at intervals. This achieves even cooking.

INFORMATION

If the current cooking process is stopped manually, a window appears under certain circumstances with *Cooking program has been interrupted*.

You then have the opportunity to end or continue the cooking program.

4.10.5 Modifying the cooking program

INFORMATION

Tabs are available only within cooking programs or the cooking step display. Tapping the tabs provides faster access to their functions.

INFORMATION

The current step in the cooking program is highlighted and can be modified. All settings of a step can be modified.

INFORMATION

After the settings are made, the modified cooking program can be saved. The cooking program is overwritten if a new cooking program name is not specified.

Modifying a cooking program after the program has started

Prerequisite Cooking program started
Cooking program has not elapsed

1. Modify the settings for the current step.
 - ↳ The modifications of the step become active immediately.
 - ↳ The modifications of the step are displayed.
 2. Tap the "Continue" field.
 - ↳ The active step is being ended.
 - ↳ The next step is being started.
 - ↳ Steps advance in the *Settings* window.
- ↳ The cooking program is modified.

Modifying a cooking program before the program has started

Prerequisite Cooking program open
Cooking program not started

1. Modify various steps.
 2. Use a swipe gesture to reach the individual step to be modified.
 3. Modify the settings for the step.
 - ↳ The modifications of the step are displayed.
 - ↳ The cooking program can be started without being saved.
 - ↳ If the modifications are to be saved, continue with the next step.
 4. Tap the *green* tab.
 - ↳ The *Tab* window is open.
 5. Save the cooking program.
 - ↳ All modifications to the cooking program are saved.
- ↳ The saved cooking program is modified.

4.10.6 Deleting a cooking program

Prerequisite Cooking program open
Cooking program not started

1. Tap the *Additional functions* tab.
 - ↳ The *Tab* window is open.
2. Tap the "Delete cooking program" field.
 - ↳ The *Delete* window is displayed.

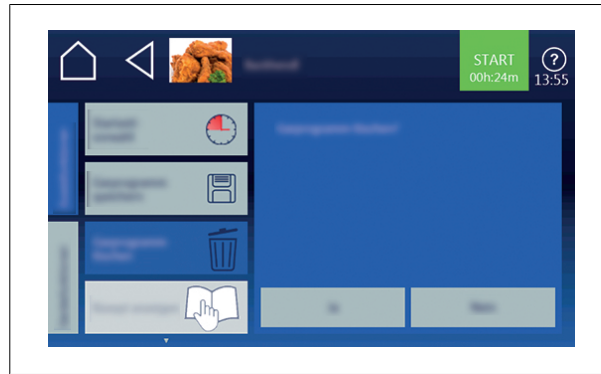

3. Tap the "Yes" button.
 - ↳ The cooking program is deleted.
 - ↳ The *Confirm* window is displayed.
4. Tap the *Confirm* button.
 - ↳ The *Additional functions* tab closes.
 - ↳ The cooking program has been deleted.

4.10.7 Exporting and importing a cooking program

Exporting cooking programs

When exporting, all cooking programs that you created in the cookbook are exported.

INFORMATION

Previously exported cooking programs on the USB stick will be overwritten.

Prerequisite USB stick inserted

Automatic cooking open

Cooking programs that you created are saved in the cookbook

1. Tap the "autoChef" button in the information strip.
 - ↳ The *autoChef* window opens.
2. Tap the "Export cooking programs" field.
 - ↳ The *Operating instructions* window opens.
 - ↳ Read the operating instructions displayed.



3. Tap the *OK* button.
 - ↳ All cooking programs that you created are exported from the cookbook to the USB stick.
 - ↳ The *Confirm* window is displayed.
 4. Tap the *OK* button.
 - ↳ Close the *Confirm* window.
- ↳ The cooking programs have been exported.

Importing cooking programs

When importing, the new cooking programs are added to the cookbook.

INFORMATION

Existing cooking programs can be overwritten or the file names of the imported cooking programs can have a supplement added.

Prerequisite USB stick inserted

"Automatic cooking" menu open.

1. Tap the "autoChef" button in the information strip.
 - ↳ The *autoChef* window opens.
2. Tap the "Import cooking programs" field.
 - ↳ The *Operating instructions* window opens.
 - ↳ Read the operating instructions displayed.



3. Tap the *Confirm* button.
 - ↳ All cooking programs on the USB stick are imported into the cookbook.
 - ↳ The *Operating instructions* window is displayed.
4. Tap the "OK" button.
 - ↳ The cooking programs have been imported.

4.11 VideoAssist

4.11.1 Watching a video

Prerequisite Videos saved on the unit.

1. Open the *Unit functions* menu.
2. Open the *Display videos* menu.

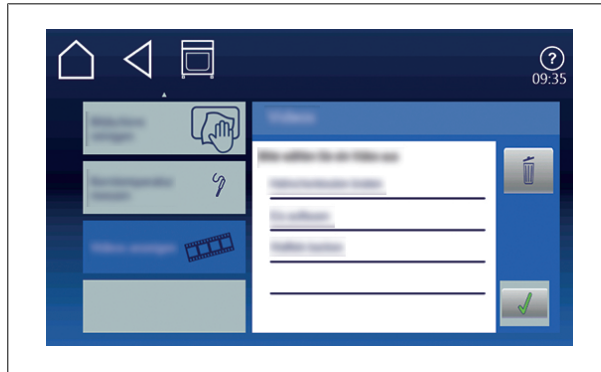

3. Select the video by tapping it.
 4. Tap the *Confirm* button.
- ↳ The video is played.

4.11.2 Deleting a video

Prerequisite The *Display videos* menu is open.

1. Tap the field *Delete* .
↳ The *Delete* field becomes dark.
2. Tap the videos to be deleted.
↳ The *Delete* symbol appears behind the designation of the video.
↳ If you tap again on the video, the selection deletes this video.

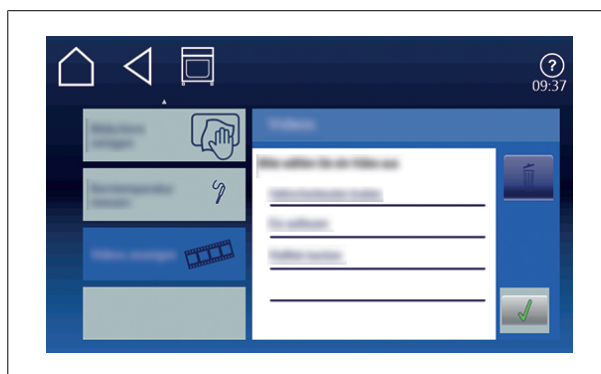

3. Touch the *Confirmation* field.
- ↳ The marked videos are deleted.

4.12 Pausing and ending operation

Switch off the unit during pauses and at end of operation.

4.12.1 Performing a hygiene flush after an extended period of idleness

For reasons of hygiene, flush the water lines in the unit and on-site water lines before using the unit.

Interruption in operation of more than 2 days

Prerequisite GN-containers, baking sheets and grates removed from the cooking chamber

No food to be cooked in the cooking chamber

1. Use AutoShower to rinse for 1 minute (see "Starting AutoShower").
2. Run the steaming cooking mode form 7 minutes at 100 °C (212 °F).

Interruption in operation of more than 7 days

Prerequisite GN-containers, baking sheets and grates removed from the cooking chamber

No food to be cooked in the cooking chamber

1. Use AutoShower to rinse for 5 minutes (see "Starting AutoShower").
2. Run the steaming cooking mode for 1 hour at 100 °C (212 °F).

5 Cleaning and caring for the unit

CAUTION

Risk of burns from hot surfaces

- Allow surfaces to cool prior to cleaning.

NOTICE

Risk of property damage from extremely abrupt cooling

- Do not shock the unit by cooling it abruptly.

NOTICE

Risk of property damage from improper cleaning

- Do not clean the unit with a high-pressure cleaner or water jet.

CAUTION

Risk of chemical burns from cleaning agent

- Follow the instructions of the cleaning agent manufacturer.
- Take appropriate protective measures when handling aggressive cleaning agents.

5.1 Preventing corrosion

- Keep the surfaces of the unit clean, with access to air.
- Remove lime, grease, starch and protein deposits from the unit's surfaces.
- Remove salt accumulations.
- Expose parts made from non-rusting steel only briefly to contact with highly acidic foods, spices, salts or the like.
- Avoid damaging the stainless steel surface with other metal items, for instance, steel spatulas or steel wire brushes.
- Prevent contact with iron and steel, for instance, steel wool and steel spatulas.
- Do not use bleaching or chlorine-containing cleaning agents.
- Clean contact surfaces with water.

5.2 Removing rust spots

- Remove fresh rust immediately with a mild abrasive or fine sandpaper.
- Always remove rust spots completely.
- Expose treated areas to fresh air for at least 24 hours. During this time, do not allow any contact with greases, oils or foods so that a new protective layer can form.

5.3 Cleaning the housing

Prerequisite Unit switched off and cooled down

→ Clean the housing with warm water and a commercially available detergent.

5.4 Cleaning the door handle, operating elements and control panel

NOTICE

Risk of property damage from improper cleaning

- Do not clean the surface with abrasive or chemically aggressive cleaning agents.
- Do not clean the surface with abrasive sponges.

Prerequisite Unit dead

→ Clean the door handle, operating elements and control panel with a damp cloth and commercially available detergent.

5.5 Cleaning the touchscreen

NOTICE

Risk of property damage from improper cleaning

- Do not clean the touchscreen with highly abrasive or chemically aggressive cleaning agents.
- Do not clean the touchscreen with highly abrasive sponges.

INFORMATION

A cleaning step with a duration of 10 seconds is provided. During this time, the touchscreen cannot be operated.

Prerequisite *Unit function* menu displayed

1. Tap the "Clean touchscreen" field.
 - ↳ The touchscreen no longer responds when touched.
 - ↳ The *Cleaning* window is displayed.
 - ↳ The cleaning duration is updated.
2. Clean the touchscreen during these 10 seconds.
 - ↳ The *Cleaning* window closes.
 - ↳ The *Unit function* menu is displayed.
 - ↳ The touchscreen has been cleaned.

5.6 Cleaning the door seal

NOTICE

Risk of property damage from improper cleaning

Animal fats in combination with high temperatures can damage the door seal very quickly if it is not maintained properly.

- Clean the door seal regularly.
- Do not use aggressive cleaners.

INFORMATION

During automatic cleaning and semi-automatic cleaning, the outside surface of the door seal is not cleaned.

The door seal must be cleaned separately.

INFORMATION

If the unit is used primarily for roasting, also clean the door seal during pauses in use.

→ When finished using the unit, clean the door seal with warm water and a commercially available detergent.

5.7 Cleaning the cooking chamber door

⚠ CAUTION

Risk of burns from hot surfaces

- Allow surfaces to cool prior to cleaning.

NOTICE

Risk of property damage from improper cleaning of the surface

- Do not use abrasive cleaners or cloths.
- Do not use grill cleaners.

NOTICE

Risk of property damage from improper cleaning

- Do not clean the surface with abrasive or chemically aggressive cleaning agents.
- Do not clean the surface with abrasive sponges.

5.7.1 Cleaning the door with hygienic glazing

→ Remove residual calcium deposits from the glass window with vinegar or citric acid.

5.8 Cleaning the steam outlet

NOTICE

Risk of property damage from deposits

- Inspect the steam outlet nozzle and connected piping for deposits.

INFORMATION

Use a liquid cleaner containing at most 20% sodium or potassium hydroxide.
Rinsing with water is not necessary.

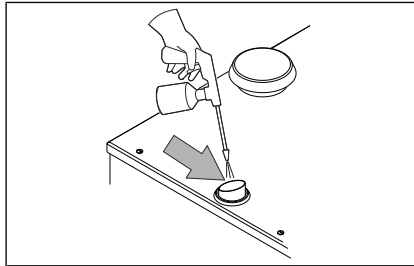

Image: Cleaning the steam outlet

1. Examine the steam outlet nozzle and connected piping for deposits.
2. Spray liquid cleaner into the steam outlet nozzle.

INFORMATION

Does not apply to built-in units.

5.9 Cleaning the recirculation hood (optional)

⚠ CAUTION

Risk of fire from dirt and grease accumulation

- Clean the hood after use.
- Follow the cleaning instructions.

⚠ CAUTION

Risk of burns from hot surfaces

- Allow surfaces to cool prior to cleaning.

⚠ CAUTION

Risk of injury from sharp edges

- Wear protective gloves.

INFORMATION

Note the cleaning and care information in the maintenance instructions for the recirculation hood.

5.10 Removing calcium deposits from the unit

INFORMATION

For manual descaling, fill commercially available descaler into hand pressure spray gun.

Prerequisite Cooking chamber temperature less than 40 °C (104 °F)
Cooking chamber cleaned

1. Spray commercially available descaler into the cooking chamber.
2. Allow to act for 30 minutes.
3. Rinse the cooking chamber thoroughly.
4. Examine the cooking chamber for any remaining calcium deposits.
5. If necessary, repeat the decalcification.
6. Open the cooking chamber door and leave it ajar until the unit is used again.
 - ↳ This extends the service life of the door seal.
 - ↳ No moisture builds up in the cooking chamber.

5.11 Using WaveClean to clean the cooking chamber automatically (optional)

CAUTION

Risk of chemical burns

Keep the cooking chamber door closed during the cleaning cycle.

INFORMATION

Note regarding cleaning agents

The use of unsuitable cleaning agents normally will damage the units. We have made a great effort to offer a cleaning agent that provides exceptional cleaning but does not attack or damage the convection steamer. We thus recommend that only our own cleaning agent be used. We assume no responsibility or liability for damage caused by unsuitable cleaning agents. Claims against us cannot be justified on the basis of such damage, not even in the context of warranty or guarantee.

INFORMATION

Cooling the temperature sensor in order to start the cleaning process sooner is not allowed. The whole cooking chamber must be cooled down to 60 °C (140 °F) for effective cleaning.

INFORMATION

Depending on the cleaning level selected, the fan may be idle for up to 60 minutes. This does not mean that cleaning has been interrupted; it is a normal part of the cleaning program.

INFORMATION

Forced rinse

Automatic forced rinse is triggered in the following situations.

- Cleaning is canceled manually. Canceling within the first 10 minutes of cleaning does not trigger an automatic forced rinse.
- Cleaning is canceled automatically in the event of a fault.
- The combi-steamer is switched off and then back on during cleaning. An automatic forced rinse begins when the unit is switched back on.

INFORMATION

If the automatic forced rinse is canceled, it starts again from the beginning.

It is not possible to start a cooking program before the forced rinse run to completion.

5.11.1 Preparing for cleaning

NOTICE

Risk of property damage from improper cleaning

- Do not clean the unit with a high-pressure cleaner or water jet.

Prerequisite

GN containers, baking sheets and grates removed from the cooking chamber

1. Remove any food remains from the cooking chamber.
 - ↳ The drainage sieve is not obstructed.
2. Leave only the hang-in frame in the cooking chamber in tabletop units and the tray trolley in the cooking zone in pedestal units.
3. Close the cooking chamber door.

5.11.2 Selecting the cleaning level

INFORMATION

Despite different cleaning durations, all cleaning steps require the same amount of water.

Tip

In the case of automatic cleaning overnight, we recommend the "medium" or "intensive" cleaning level. This ensures adequate drying.

Prerequisite

Unit switched on
Main menu displayed

1. Tap the "WaveClean" button.
2. Selecting the cleaning level.
 - ↳ The *Operating instructions* window is displayed.
3. Tap the *Confirm* button.
 - ↳ The *Select cleaning level* window is displayed.

4. Tap the "START STOPP" button.

↳ If necessary, the cooking chamber is cooled down until the cleaning temperature of 60 °C (140 °F) is reached.

5.11.3 Inserting the cleaning cartridge

INFORMATION

Use only cleaning cartridges with an undamaged wax seal.

If the wax seal is damaged, the cleaner can enter the cleaning circuit prematurely or not dissolve completely, so that complete cleaning is no longer assured.

Insert the cleaning cartridges only when requested to do so.

INFORMATION

Never operate the unit in the automatic cleaning mode without a cleaning cartridge.

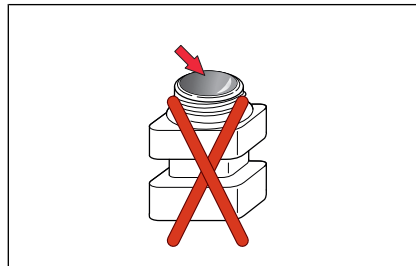

Image: Wax seal on the cleaning cartridge damaged

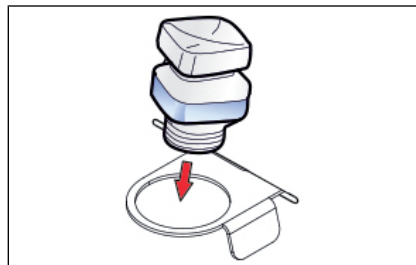

Image: Insert the cleaning cartridge in the holder

Prerequisite Cleaning cartridge sealed and undamaged

1. Open the cooking chamber door.
2. Open the lid of the cleaning cartridge.
3. Place the cleaning cartridge in the holder on the air diverter.
4. Close the cooking chamber door.

5.11.4 Starting automatic cleaning

INFORMATION

Never operate the unit in the automatic cleaning mode without a cleaning cartridge.

- Requirements**
- Water connection is open
 - The unit is on
 - Cleaning level selected
 - Cleaning cartridge inserted
 - Cooking zone temperature at 60 °C (140 °F)
- Tap the "START STOPP" button.
- ↳ The display shows the remaining time.

5.11.5 Canceling automatic cleaning

1. Tap the "Stopp" button.
 - ↳ Automatic cleaning is canceled.
 - ↳ Automatic rinsing starts and cannot be canceled.
 - ↳ Upon completion, a prompt appears to remove the cleaning cartridge.
2. Remove the cleaning cartridge.

5.11.6 Ending automatic cleaning

CAUTION

Risk of chemical burns

Dripping liquid can contain chemically aggressive components; it is thus necessary to take appropriate protective measures.

Prerequisite Automatic rinsing has stopped after the cleaning program was cancelled or the cleaning time has elapsed

1. Open cooking chamber door.
2. Remove the empty cleaning cartridge.
3. Use the hand shower to thoroughly rinse out any remaining cleaner or rinsing agent.
4. Close the cooking zone door.
 - ↳ After the cooking chamber door is closed, the cleaning program is completed.
5. Use a gentle stream of water to flush away any drops of cleaning water that have collected on the floor in front of the unit.
6. Open the cooking chamber door and leave it ajar until the unit is used again.
 - ↳ This extends the service life of the door seal.
 - ↳ No moisture builds up in the cooking chamber.

5.12 Cleaning the cooking chamber manually

5.12.1 Preparing the cooking chamber

NOTICE

Risk of property damage from improper cleaning

- Do not clean the unit with a high-pressure cleaner or water jet.

Prerequisite GN containers, baking sheets and grates removed from the cooking chamber

1. Remove any food remains from the cooking chamber.
↳ The drainage sieve is not obstructed.
2. Leave only the support rack in the cooking chamber.
3. Close the cooking chamber door.

5.12.2 Starting the cleaning program

Prerequisite Unit is on

→ Tap Manual cleaning.

5.12.3 Spraying the cleaner

⚠ CAUTION

Dangerous situation

Failure to observe precautions can result in slight to moderately severe injuries.

- Wear protective clothing.
- Wear breathing protection.

NOTICE

Risk of property damage from exceeding the recommended acting time of the cleaner

- Do not allow the cleaner to act longer than specified by the program.

1. The menu field displays the instruction "Spray cleaner"
2. Put on protective clothing, safety goggles and protective gloves
3. Open cooking chamber door.
4. Spray the cooking chamber, heat register and fan wheel with cleaner.

5.12.4 Allowing the cleaner to act

→ Close the cooking chamber door.

↳ The acting time starts.

↳ The display shows the remaining time until the "Flush cooking chamber" stage.

5.12.5 Starting cleaning

- The acting time has elapsed, the cleaning process starts automatically.
 - ↳ The cooking chamber is heated.
 - ↳ The display shows the remaining time.

5.12.6 Drying the cooking chamber

Prerequisite Cooking chamber door closed

1. The drying process starts automatically.

INFORMATION

The cooking chamber is heated.

2. After the end of the drying process, a signal sounds.
 - ↳ "End" appears on the display.
3. Open the cooking chamber door and leave it ajar until the unit is used again.
 - ↳ This extends the service life of the door seal.
 - ↳ No moisture builds up in the cooking chamber.

5.13 Removing and installing the air diverter

CAUTION

Pinch hazard from rotating fan

- Before working on the unit, ensure that the unit has been disconnected from the power supply.
- Do not operate the unit without the air diverter.

Removing the air diverter

Prerequisite Unit dead

1. Remove core temperature sensor from holder.
2. Remove right and left hang-in frames.
3. Remove water supply pipe with the aid of a tool.
4. Take air diverter off the pins.

Installing the air diverter

1. Place the air diverter on the pins.
2. Use tool to close upper fastener.
3. Use tool to close lower fasteners.
4. Use tool to install water supply pipe.
5. Insert right and left support racks.
6. Insert core temperature sensor into holder.

5.14 Inspecting the unit

5.14.1 Performing a visual inspection

NOTICE

Risk of property damage from improper inspection

- Inspect in accordance with the inspection intervals.
- Have the test performed by a competent operator.
- In the event of damage or signs of wear, contact customer service immediately and stop using the unit.

Prerequisite Unit disconnected from the electric supply mains
Unit empty and cleaned
Cooking chamber door opened completely

→ Inspect housing, cooking chamber door and cooking chamber yearly for deformation and damage.

↳ Visual inspection has been performed.

5.14.2 Using CombiDoctor to run the self-diagnosis program (optional)

INFORMATION

Incorrect results are displayed when the unit is warm. Allow the unit to cool down.



Image: Selecting the self-diagnosis program setting

- | | | | |
|---|------------------------|---|---------------------|
| a | Roller | c | Setting window |
| b | Remaining time display | d | "CombiDoctor" field |

Prerequisite Water connection open

Power optimization system deactivated (optional)

Cooking chamber empty, no grates and no containers, with hang-in frame or tray trolley

Unit switched on

No faults displayed

Settings menu displayed

1. Tap the "CombiDoctor" field.
 2. Use a swipe gesture to set the roller to the desired self-diagnosis program.
 - ↳ The self-diagnosis program set displays the operating time.
 3. Press the "START" button.
 - ↳ A help text is displayed.
 4. Briefly open and close the cooking chamber door.
 - ↳ The self-diagnosis program continues automatically.
- ↳ Once self-diagnosis has concluded, the result is displayed. Note any fault message and forward it to your customer service.

6 Troubleshooting

If a fault occurs during operation, the fault number and fault message are displayed.

If the cooking results or cleaning results with WaveClean vary without a fault message being displayed, use CombiDoctor to analyze the cause.

6.1 Emergency operation

In order to allow limited use in case of error, the unit has several different emergency programs. Emergency operation is activated automatically and displayed. After elimination of the error indicated, the controls switch back into normal operation automatically. A reset is not necessary.

INFORMATION

Emergency programs handle the limited further operation of the appliance until servicing. Deviating cooking results and temperature deviations are possible.

6.2 Cause of error and remedy

Error no.	Fault message displayed	Description	Action
694 695	<ul style="list-style-type: none"> Cooking sensor defective 	The internal core temperature sensor assumes the function of the defective cooking chamber sensor.	<ul style="list-style-type: none"> Insert the internal core temperature sensor into its holder. This can lead to a different cooking result. Contact customer service.
699 700 714 716	<ul style="list-style-type: none"> Internal core temperature sensor defective 	The internal core temperature sensor in the cooking chamber is deactivated.	<ul style="list-style-type: none"> If possible, use the external core temperature sensor (optional). Select a different cooking program. Contact customer service.

Error no.	Fault message displayed	Description	Action
710	• Vapour sensor defective	Steam elimination is now controlled solely by the software. This results in higher water consumption.	• Contact Customer service
	• Water pressure too low	As continuous fault message	• Open the water valve • If water valve not closed, contact customer service
	• Water pressure too low	As sporadic fault message	• Activate fewer appliances simultaneously in the kitchen. • Contact Customer service
	• No water in the siphon	The siphon is insufficiently filled with water.	• Open the water valve • 2 l (0,53 gal) Pour water into the cooking chamber • If the fault message does not disappear, contact customer service
	• Unit restarted after power failure	If there was no power failure in the kitchen, an operating error may be involved. For instance, unintentionally switching on and off while a cooking program was running.	• Power failure < 1 minute • Confirm the power failure message • Continue the cooking program • No cleaning necessary • Power failure > 1 minute • Cooking program cancelled • Run the cleaning cycle
	• WaveClean cancelled	• Heed the explanations and instructions in the "Automatic cleaning (WaveClean)" chapter	

6.3 Nameplate

When contacting customer service, please always provide the following data from the nameplate:

Serial number (SN)	
Type number (TYP)	

7 Carrying out maintenance

The manufacturer recommends professional cleaning of the unit by trained technical personnel in 12-month intervals. With a heavier use, a maintenance interval of 6 months is recommended.

8 Disposing of unit in an environmentally responsible manner

The unit has been designed to provide a lifetime of 10 years with average use.

Do not dispose of unit or the unit's components together with non-recyclable waste. If the unit is disposed of together with non-recyclable waste or treated improperly, toxic substances contained in the unit can damage health and pollute the environment.

Dispose of the unit in accordance with local regulations for used appliances. Clarify any open questions with the responsible agencies (for instance, solid waste management).

Unit In addition to valuable materials, used electrical and electronic equipment also contains harmful substances that were needed for their operation and safety.

Cleaning agents Dispose of leftover cleaning agents and cleaning agent containers in accordance with the information provided by the cleaning agent's manufacturer. Observe applicable regional regulations.

Residues from cooking Residues from cooking and food must be collected in suitable containers and disposed of in accordance with the regionally applicable regulations.

Keyword index

A		
Automatic cooking (autoChef)		
Deleting a cooking program	73	
Automatic cooking (autoChef)		
Exporting a cooking program	74	
Finding and opening a cooking program ..	71	
Importing a cooking program	75	
Modifying the cooking program	73	
Automatic forced rinse	83	
C		
Changing basic settings	29	
ChefsHelp	19	
Cleaning		
Automatic cleaning (WaveClean)	83	
Cleaning cartridge (WaveClean)Cleaning	84	
Locking the touchscreen	79	
Manual cleaning	86	
ClimaSelect plus	20	
Combisteamng	17	
Continue cooking	20	
Core temperature		
Core temp. measurement	21	
Core temperature measurement		
4-point core temperature sensor		
measurement	60	
Setting the core temperature	41	
Standard setting value	24	
D		
Delta-T cooking	18	
F		
FamilyMix	20	
H		
HACCP	59	
Hot air	18	
I		
Idle time	20	
Inhibit operation	33	
L		
Low-temperature cooking	18	
M		
Main menu	21, 28	
Manual cooking	61	
Creating a cooking program step	62	
Creating and saving a cooking program ...	64	
Exporting a cooking program	69	
P		
PerfectHOLD	18	
Q		
QualityControl	20	
R		
RackControl	19	
Ready2Cook	19	
Regeneration	18	
Retrieving unit information	31	
S		
Self-diagnosis (CombiDoctor)	88	
SES	19	
Setting favorites	32	
Setting the cooking time	38	
Setting the fan	42	
Settings		
Setting the date and time	31	
Start time selection	19	
Steaming	17	
Manual	20	
T		
Temperature		
Setting the cooking temperature	37	
Standard setting value	24	
Time2Serve	20	
V		
Video		
Delete video	76	
Import video	36	



Henny Penny Corp., Eaton, Ohio 45320, Revised 7/5/2022