

Get the best,  
in every aspect

MCC Ambient full serve  
displays  
4 shelves



## Fri-Jado's MCC food displays offer you the best, in every aspect



Maximum transparency - best view of your food

Total Visibility



High capacity in a small footprint saves valuable floor space



Unlimited combination options with other MCC models, thanks to modular design



Made from 99% recyclable components in a solar powered factory

Green Efficiency

### Also available in the MCC Range

- MCC Ambient self-serve with doors on customer side
- MCC Hot self-serve
- MCC Hot self-serve humidified with doors on customer side
- MCC Hot full serve humidified
- MCC Cold self-serve
- MCC Cold self-serve with doors on customer side
- MCC Cold full serve

### MCC Ambient full serve

#### Features

- 4-level full serve food display cabinet
- 24, 36 or 48 inches wide
- Available with underframe or as a drop-in version that can be integrated in any store concept
- Underframe available in any RAL color
- Mirror glass sliding doors on the operator side
- Slim transparent shelves with adjustable height and angle
- LED lighting with natural color reproduction on each shelf
- Fixing system for price rails included
- Total shelf display area:
  - MCC 24-4: 10.52 ft<sup>2</sup>
  - MCC 36-4: 16.79 ft<sup>2</sup>
  - MCC 48-4: 23.14 ft<sup>2</sup>

#### Accessories

- Bumper (underframe models)
- Caster set (underframe models)



Fixing system for price rails



Accessories - Bumper



Accessories - Caster set



Models on underframe or drop-in version

	MCC 24-4 Ambient full serve	MCC 36-4 Ambient full serve	MCC 48-4 Ambient full serve
Width	23 5/8 "	35 7/16"	47 1/4 "
Depth	29 1/2 "	29 1/2 "	29 1/2 "
Height on stand	55 7/8"	55 7/8"	55 7/8"
Height drop-in above worktop	33 1/16"	33 1/16"	33 1/16"
Weight net / gross	287 / 344 lbs	357 / 428 lbs	428 / 511 lbs
Voltage	1~ 115V	1~ 115V	1~ 115V
Frequency	50/60 Hz	50/60 Hz	50/60 Hz
Power	0.03 kW	0.05 kW	0.07 kW
Max. nominal current	0.2 A	0.4 A	0.6 A
Electrical connection*	NEMA 5-20P	NEMA 5-20P	NEMA 5-20P

\* Length power cord appr. 8 1/3 ft

### MCC Ambient full serve on underframe

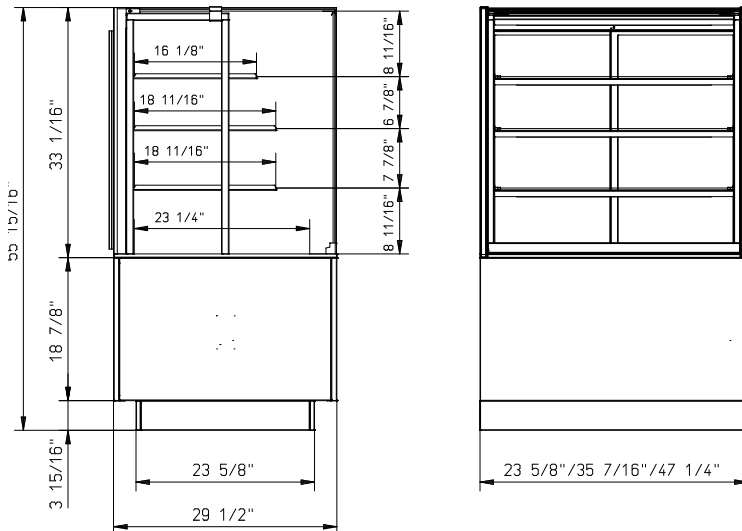

### MCC Ambient full serve drop-in

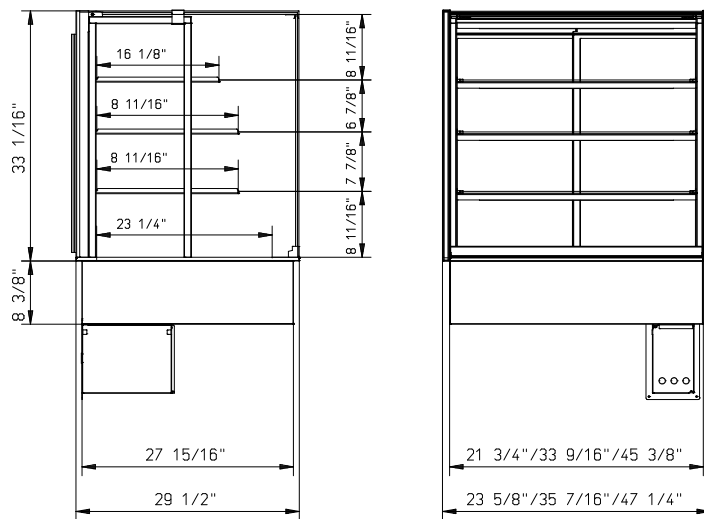

Specifications and technical data are subject to amendment without prior notice.

These are basic drawings. For more detailed technical information, please visit frijado.com.

The MCC Ambient is ETL listed (meets UL standard 197, NSF standard 4 and CSA standard C22.2 No. 109).



Fri-Jado Inc.  
1401 Davey Road  
Suite 100  
Woodridge IL 60517  
Toll free 877-374-5236  
e-mail us.info@frijado.com  
www.frijado.com